



**National Small Industries Corporation Limited
(A Government of India Enterprise)**

Tender Ref. no. 5(23)/2021-22/MS/IITF-2021 dated: 18.10.2021

Name of Tender: "Conceptualization, Fabrication, Operation & Maintenance of MSME theme Pavilion & VIP Lounge including associated work & services for the period of IITF exhibition during participation of Office of DC-MSME, Ministry of MSME, Government of India and NSIC LTD at 40th India International Trade Fair, 2021 at Pragati Maidan, New Delhi from 14th to 27th November, 2021"

Date: 30.10.2021

Corrigendum- III
Clarification to Bidders' Queries

S. No	Tender Applicable Clause No.	Tender Clause Description	Query	Reply
1	Clause No. 4: Point 1&2 under Scope of Work And Technical Specification of Items of E- Bid	1. Indicative Floor Plan Designing, Fabrication & Furnishing Of MSME Theme Pavilion 49 sqm. 2. VIP Lounge-(20 sqm)	It has been mentioned in the tender document that the theme total area is 49 sqm but in the layout it is showing 40 sqm. Also in the layout there is an office area of 28 sqm but in the tender VIP lounge area is 20 sqm. Kindly clarify which area to take & exact dimensions with how much side these areas are open.	The Theme-Foyer marked as 40 sqm in the Indicative Floor Plan of the said tender may be read as 49 sqm and VIP Lounge marked as 29 sqm in the Indicative Floor Plan as 20 sqm. Theme Pavilion will be three side open and VIP Lounge, will be closed on all sides with entry & exit gates on one side.
2	Clause No. 4: Point 1 under Scope of Work And Technical Specification of Items of E- Bid	1. Indicative Floor Plan Designing, Fabrication & Furnishing Of MSME Theme Pavilion 49 sqm.	Marking of NSIC 49 sqm area is not marked on the indicative floor plan layout given in the tender. Request to share the marked floor plan and indicate the location, number of open sides etc for the designing purpose.	Please refer the reply at S. No. 1 However, floor plan with indication is attached.

All other term& conditions of the published tender remain same.

This Corrigendum shall form part of the aforesaid Tender.

(Sunil Tyagi)

General Manager-SG (Exhibition)

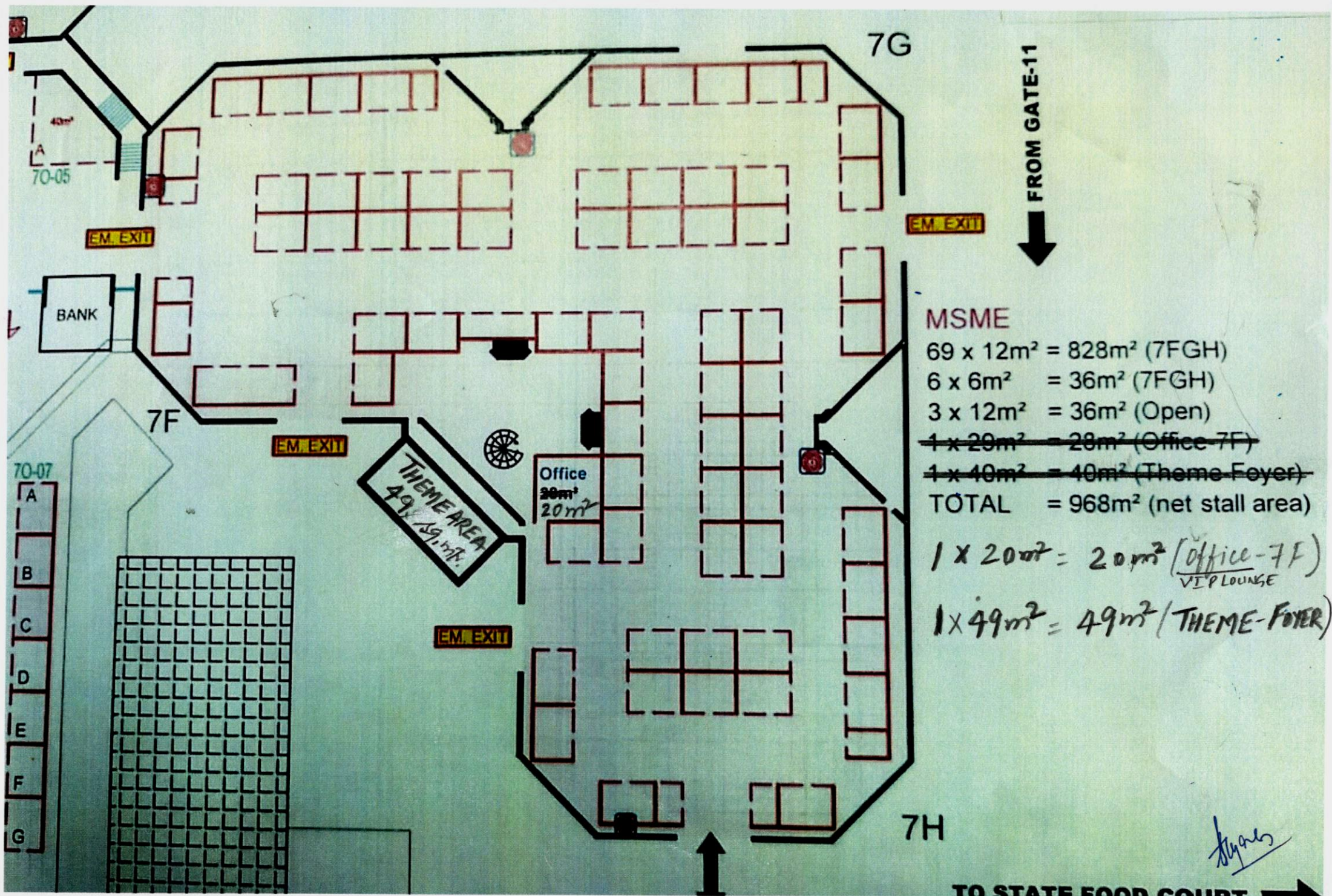

MSME

- 69 x 12m² = 828m² (7FGH)
- 6 x 6m² = 36m² (7FGH)
- 3 x 12m² = 36m² (Open)
- ~~1 x 20m² = 20m² (Office-7F)~~
- ~~1 x 40m² = 40m² (Theme Foyer)~~
- TOTAL = 968m² (net stall area)
- 1 x 20m² = 20m² (Office-7F)
VIP LOUNGE
- 1 x 49m² = 49m² (THEME-FOYER)

TO STATE FOOD COURT

Slyans