

एन एस आई सी
N S I C

**TENDER FOR
CONSTRUCTION OF TOILET BLOCK
AT
NSIC EXHIBITION GROUND,
NSIC COMPLEX, OKHLA INDUSTRIAL ESTATE,
NEW DELHI-110020**

THE NATIONAL SMALL INDUSTRIES CORPORATION LTD.

(A Government of India Enterprise)

**NSIC Bhawan, Okhla Industrial Estate,
New Delhi-110020**

Tel No. 011-26926275

Web-link for downloading tender document:

NSIC web site: <https://www.nsic.co.in/tender/Current-Tenders>

and

CPP Portal: <https://eprocure.gov.in/epublish/app>



**THE NATIONAL SMALL INDUSTRIES CORPORATION LTD.
(A GOVERNMENT OF INDIA ENTERPRISE)
NSIC Bhawan, Okhla Industrial Estate,
New Delhi-110020
Tel No. Tel No. 011-26926275**

Ref: - SIC/HO/MIS/Exhi. Hall/21-22

Date: 07.10.2022

M/s. _____

Sub: Construction of Toilet Block at NSIC Exhibition Ground, NSIC Complex, Okhla Industrial Estate, New Delhi-110020.

Sir/ Ma'am,

Tender document in respect of the above mentioned works containing 42 pages as detailed on page 4 (Index) are forwarded herewith. *Please note that tender is to be delivered in the office of the Deputy General Manager (Contract & Procurement), The National Small Industries Corporation Ltd., Okhla Industrial estate, New Delhi-110020 on or before 31.10.2022 up to 3.00 P.M.*

The Tender should be signed on each page, dated and witnessed in all places provided for in the documents; all other papers should be initialed.

The tender should be accompanied by tender fee and Earnest Money Deposit (EMD) in the form of demand draft as mentioned in Appendix. Tenders without tender fee and earnest money deposit shall be summarily rejected. The Technical Bids will be opened on 31.10.2022 at 3.30 P.M. and Price Bids of technically qualified Bidders will be opened at a later date with intimation. The security deposit, performance deposit, EMD can be submitted in the form of surety bonds also.

The person, signing the tender on behalf of company/ firm or on behalf of another person shall attach with tender a certified copy of proper authority/ power of attorney on a non-judicial stamp paper of requisite value duly executed in his favour by such person, company/ firm and must state specifically that he has authority to sign such tenders for and on behalf of such person or company/ firm as the case may be, and in all matters pertaining to the contract including arbitration clause.

This letter shall form part of the “**CONTRACT**” and must be signed and returned along with the tender documents.

Encl. 43 Pages

Yours faithfully

**Deputy General Manager
Contract & Procurement Cell
NSIC Limited,
Head Office,
New Delhi**

Signature of the Bidder



NOTICE INVITING TENDER

Tender notice for Construction of Toilet Block at NSIC Exhibition Ground, NSIC Complex, Okhla Industrial Estate, New Delhi-110020.

Ref: - SIC/HO/MIS/Exhi. Hall/21-22

Date: 07.10.2022

NSIC invites open tenders in percentage rate basis from **eligible and experienced contractors** who have successfully completed similar works during last seven (7) years ending 31.03.2022. Eligibility criteria for this work, (i) Three similar works costing not less than Rs. 15,15,200/- each, or (ii) Two similar works costing not less than the amount of Rs. 18,94,000/- each or (iii) One similar work costing not less than Rs. 30,30,400/- for carrying out the following work. The values mentioned are exclusive of GST.

S. No.	Name of the work	Estimated cost (Rs. lakh) excl. GST	Earnest Money Deposit (EMD)/ Bid Security (Rs)	Completion Time	Issue of Blank Tender Document	Last Date of Submission Tender
1.	Construction of toilet block at NSIC Exhibition Ground, NSIC Complex, Okhla Industrial Estate, New Delhi-110020	37.88	75,760/-	120 days	From 07.10.2022 to 31.10.2022 Within office hours.	31.10.2022 upto 3.00 PM

1. The intending Tenderers may download the complete tender document available on the NSIC website: <https://www.nsic.co.in/tender/Current-Tenders> and CPP Portal: <https://eprocure.gov.in/epublish/app> Duly filled tenders are to be submitted along with requisite tender fee, EMD and supporting documents on or before the due date and time of submission at Nsic Ltd., NSIC Bhawan, Okhla Industrial Estate, New Delhi -110020.
2. Tenderers registered as Micro and Small Enterprises (MSEs) as defined in MSME Procurement Policy issued by department of Micro, Small and Medium Enterprises or are registered with the Central Purchase Organization or the concerned Ministry or Department or Startups as recognized by Department of Industrial Policy and Promotion are exempted from the payment of tender fee and EMD. However, Tenderer seeking exemption from payment of tender fee and EMD shall submit the proof of the same along with their technical bid.
3. Intending Tenderers should have valid registration with appropriate authorities for statutory taxes/ GST as applicable.
4. The intending Tenderers should have satisfactorily completed similar works during last 7 (seven) years ending 31.03.2022. Eligibility criteria for this work, (i) Three similar works costing not less than Rs. 15,15,200/- each, or (ii) Two similar works costing not less than the amount of Rs. 18,94,000/- each or (iii) One similar work costing not less than Rs. 30,30,400/-. Similar nature work means: - "**Construction of building works**". The values mentioned above are exclusive of GST.
5. Tender documents can be downloaded from NSIC website: <https://www.nsic.co.in/tender/Current-Tenders> and CPP Portal: <https://eprocure.gov.in/epublish/app>.
6. The tender documents duly completed along with tender fee and earnest money deposit (if not eligible for exemption) in form of Demand Draft/Pay Order in favour of the "The National Small Industries Corporation Ltd" payable at New Delhi from any Nationalized Bank/Scheduled bank will be submitted at the office of the *Deputy General Manager (Contract & Procurement), The National Small Industries Corporation Ltd., Okhla Industrial estate, New Delhi-110020* upto 3.00 PM on



31.10.2022. Technical bid of the parties shall be opened on the same day i.e. 31.10.2022 at 3.30 PM. The tender submitted without tender fee and earnest money deposit or valid exemption certificate, shall be summarily rejected.

7. NSIC reserves the right to reject any or all the tenders without assigning any reason thereof and also not bound to accept lowest tender. Tenders in whom any of the prescribed conditions are not fulfilled or found incomplete in any respect are liable to be rejected.
8. Canvassing, whether directly or indirectly in connection with tender is strictly prohibited and the tender submitted by the contractors who resort canvassing will be liable to be summarily rejected.
9. The Technical Bid submitted by the parties shall be opened on the same day i.e. 31.10.2022 at 3.30 PM in the presence of Tenderers who wish to be present. The price bids of technically qualified parties shall be opened at a later date and the technically qualified parties shall be informed in advance about the opening of their price bid.

**Deputy General Manager
Contract & Procurement Cell,
NSIC Limited
Okhla, New Delhi**



THE NATIONAL SMALL INDUSTRIES CORPORATION LTD.
(A GOVERNMENT OF INDIA ENTERPRISE)
NSIC Bhawan, Okhla Industrial Estate,
New Delhi-110020
Tel No. Tel No. 011-26926275

Ref: - SIC/HO/MIS/Exhi. Hall/21-22

Date: 07.10.2022

INDEX OF TENDER DOCUMENTS

S. NO.	DESCRIPTION	PAGES
1.	INSTRUCTION TO TENDERERS	6 - 9
2.	GENERAL CONDITIONS OF CONTRACT	10 - 23
3.	FORM OF TENDER-CUM-BID SECURITY DECLARATION	24
4.	APPENDIX	25
5.	SPECIAL CONDITIONS OF CONTRACT	26 – 27
6.	TENDER DRAWING (indicative)	28
7.	BILL OF QUANTITIES (BOQ)/ PRICE BID (to be submitted separately in a sealed envelope)	29 - 43



INSTRUCTIONS TO TENDERERS

1.0 GENERAL

Tenderers are advised to acquaint themselves fully with the description of work, scope of services, time schedule and terms and conditions including all the provisions of the tender document before framing up their tender.

2.0 SITE PARTICULARS

Tenderers are advised to inspect and examine the site and its surroundings and satisfy themselves before submitting their tenders as to nature of work, site conditions, means of access to the site etc. Non-familiarity with the site conditions will not be considered a reason either for extra claims or for not carrying out the work in strict conformity with the specifications. For site visit and any clarification/information/ Assistance, the intending Tenderers may contact Deputy General Manager (C&P), *The National Small Industries Corporation Ltd., Okhla Industrial estate, New Delhi-110020.*

3.0 SUBMISSION OF TENDER

- a) The expression “Tender Notice” referred to in the Tender Documents shall be deemed to include any Notice/ Letter Inviting Tender with respect to the work forming the subject matter of the documents and vice-versa.
- b) The tender complete in all respects shall be submitted along with tender fee and Earnest Money Deposit (if not eligible for exemption) as stipulated in the Notice/ Letter Inviting Tender ONLY. Tenders without tender fee and Earnest Money Deposit (if not eligible for exemption) will be out rightly rejected.

Tenders shall be submitted in two separate sealed envelopes Super scribing the following: -

ENVELOPE – I (TECHNICAL BID)

Name of work Construction of toilet block at NSIC Exhibition Ground, NSIC Complex, Okhla Industrial Estate, New Delhi-110020

Tender no. : SIC/HO/MIS/Exhi. Hall/21-22 Date: 07.10.2022

Due date & time of opening: 31.10.2022 at 3.30 PM

Addressed to : Deputy General Manager (C&P), *The National Small Industries Corporation Ltd., Okhla Industrial estate, New Delhi-110020.*

From:

Name & Address of the Tenderer



This envelope shall contain the following: -

- Tender fee and EMD should be in the form of Demand Draft drawn on a scheduled/ nationalized bank in favour of “The National Small Industries Corporation Ltd.” payable at New Delhi.
- Cheque will not be accepted. The money receipt issued by NSIC regarding purchase of tender document also to be enclosed in this envelope-I. For Tender documents downloaded from website, a Demand Draft/ Banker’s Cheque of Rs. 1,180/- (Rupees One Thousand One Hundred Eighty Only) (non-refundable) including GST towards the cost of tender documents and Rs. 75,760/- towards EMD are to be enclosed in envelope –I.
- Certificates/ Documents of work experience executed during last 7 (seven) years ending 31.03.2022. Eligibility criteria for this work, (i) Three similar works costing not less than Rs. 15,15,200/- each, or (ii) Two similar works costing not less than the amount of Rs. 18,94,000/- each or (iii) One similar work costing not less than Rs. 30,30,400/- on the basis of which Bidder wishes to get qualified and copies of supporting work orders, schedule of quantities and completion certificate should be enclosed. The values mentioned above are exclusive of service tax/ GST. **In case of completion certificate issued by the private parties, TDS certificate should also be enclosed.**
- Certificate of Registration for GST.
- Partnership Deed in case of partnership firm and Articles of Association in case of limited Company.
- Power of Attorney in favour of person who has signed the tender document. In case of company, the authority to sign the tender is to be given under Board resolution.
- Copies of PAN/ TAN card.
- Complete tender document with each page signed and stamped by the Bidder.

It may be clearly noted that the filled up price bid should not be placed inside this envelope containing the technical bid. In case the filled up price bid is found inside the technical bid, such tender shall be summarily rejected.

ENVELOPE – II (PRICE BID)

Name of work : Construction of toilet block at NSIC Exhibition Ground, NSIC Complex,
Okhla Industrial Estate, New Delhi-110020

Tender no. : SIC/HO/MIS/Exhi. Hall/21-22 Date: 07.10.2022

Due date & time of opening :

Addressed to : Deputy General Manager (Contract & Procurement), *The National Small Industries Corporation Ltd., Okhla Industrial estate, New Delhi-110020.*

From: Name & address of the Tenderer

NOTE:

Envelope-I shall contain all the documents related to eligibility criteria, terms-conditions of tender documents etc. i.e. complete tender documents except Price Bid part. Envelope-II shall contain only price bid/ Schedule of Quantities to be charged by the Tenderers for execution of the work. It is to be noted that the Envelope-II shall contain only PRICES and no conditions i.e. deviations/ assumptions/ stipulations/ clarifications/ comments/ any other request whatsoever. Conditional offers will be rejected.

4.0 QUALIFYING CRITERIA

Tenderers having following valid documents will be technically qualified and considered for opening of their price bid. Technically qualified parties have no right to claim for award of the work. Corporation reserves the right to cancel or award the work to any party/ Tenderers.

- Tender fee and EMD should be in the form of Demand Draft drawn on a scheduled/ nationalized bank in favour of “The National Small Industries Corporation Ltd.” payable at New Delhi. Cheque will not be accepted. The money receipt issued by NSIC regarding purchase of tender document also to be enclosed in this envelope - I. For Tender documents downloaded from website, a Demand Draft/ Bankers cheque of Rs. 1,180/- (Rupees one thousand one hundred eighty only) (non-refundable) including GST towards the cost of tender documents and Rs. 75,760/- towards EMD are to be enclosed in envelope – I.
- Certificates/ Documents of work experience details of (i) Three similar works costing not less than Rs. 15,15,200/- each, or (ii) Two similar works costing not less than the amount of Rs. 18,94,000/- each or (iii) One similar work costing not less than Rs. 30,30,400/- executed by the Bidder during last 7 years ending on 31.03.2022, on the basis of which Bidder wishes to get qualified and copies of supporting work orders, schedule of quantities and completion certificate should be enclosed. The values mentioned above are exclusive of service tax/ GST. In case of completion certificate issued by the private institutes, TDS certificate should also be enclosed.
- Certificate of Registration for GST.
- Partnership Deed in case of partnership firm and Articles of Association in case of limited Company.
- Power of Attorney in favour of person who has signed the tender documents. In case of company, the authority to sign the tender is to be given under Board resolution.
- Copies of PAN/TAN card.

5.0 DEVIATIONS TO TENDER CLAUSES

Tenderers are advised to submit the tender strictly based on the terms and conditions and specification contained in the Tender Documents and not to stipulate any deviations. Conditional tenders are liable to be rejected.

6.0 VALIDITY OF OFFER

Tender submitted by Tenderers shall remain valid for acceptance for a minimum period of 120 days from the date of opening of the tenders. The Tenderers shall not be entitled during the said period of 120 days, to revoke or cancel their Tender or to vary the Tender price given or any term thereof, without the consent in writing of the Owner. In case of Tenderers revoking or canceling their tenders or varying any terms & price of an item in regard thereof without the consent of owner in writing, Corporation shall reject their tender forfeiting the Earnest money paid by them along with their tender without giving any notice.

7.0 AWARD OF WORK

Corporation reserves the right to split the job into two or more parts and to award the work to separate agencies/contractors. Work shall be awarded to the lowest Bidder, subject to the work experience and fulfillment of other terms & conditions and specifications

8.0 ACCEPTANCE / REJECTION OF TENDER

- i) Corporation does not bind itself to accept the lowest tender.
- ii) Corporation also reserves the right to accept or reject any tender in part or full without assigning any reason whatsoever.
- iii) Corporation also reserves the right to reject any or all the tenders at any time solely based on the past unsatisfactory performance by the Bidder(s) the opinion/ decision of NSIC regarding the same shall be final and conclusive.

9.0 CORRECTIONS;

No corrections or overwriting will be entertained in schedule of rates by using correcting fluid. All correction in the schedule of rate should be made by penning through the error and writing the corrected figure/ words in legible handwriting by the side of correction duly initialed with date and stamped .

10.0 FIRM RATES

The percentage tender premium or discount quoted by Bidder shall remain firm till completion of all works even during the extended period (if any), on any account whatsoever. It may be noted that no deviation on this account will be acceptable and offer not containing firm tender premium or discount shall not be considered.

11.0 It will be obligatory on the part of the Tenderer to sign the tender documents for all the components & parts. After the work is awarded, he will have to enter into an agreement on proforma to be provided by the Corporation for work awarded, on a non-judicial stamp paper of requisite value at his own cost within ten days from date of receipt of acceptance work order.

12.0 Any addendum/ corrigendum issued shall form a part of the tender document. There will not be any press notification on amendment/ corrigendum. The purchasers of the tender document/ the prospective Tenderers are required to visit NSIC web site: <https://www.nsic.co.in/tender/Current-Tenders> and CPP Portal: <https://eprocure.gov.in/epublish/app> for all such amendments/ corrigenda to NIT as well as the tender document.

**Deputy General Manager
Contract & Procurement Cell,
NSIC Limited
Okhla, New Delhi**

GENERAL CONDITIONS OF CONTRACT

1. Where the context so requires, words importing the singular only also include the plural and vice versa.
2. Corporation shall mean 'The National Small Industries Corporation Ltd. (NSIC) (A Government of India Enterprise) having its registered office at "NSIC Bhawan, Okhla Industrial Estate, New Delhi – 110020 which expression shall include its legal representatives, successors and permitted assigns.

3. Definition

- a) The 'Contract' means and includes the documents forming the tender and acceptance thereof together with the documents referred to therein including the conditions, the specifications, designs, drawing and instructions issued from time to time by the 'Engineer- in-charge', the formal agreement executed between the Corporation and the Contractor, and all these documents taken together shall be complementary to one another.
- b) The 'Site' shall mean the land and/ or other places on, into or through which work is to be executed under the contract or any adjacent land, path or street which may be allotted or used for the purpose of carrying out the contract.
- c) The 'Contractor' shall mean the individual or firm or company, whether corporate or not, undertaking the works and shall include the legal personal representative or such individual or the persons composing such firm or company and the permitted assignee of such individual or firm or company.
- d) The 'Competent Authority' means the Chairman-cum-Managing Director of the Corporation and his successors.
- e) The Engineer-in-charge means the Technical Officer of the Corporation, as the case may be who shall supervise and be the In-charge of the works.
- f) The Chief General Manager-SG (MIS) means the officer who holds the charge of that post in the National Small Industries Corporation Ltd., Okhla Industrial Estate, New Delhi 110020 during the currency of this agreement, to act on behalf of the Chairman of the NSIC Ltd.
- g) 'IS Specification' means the Specification of latest edition with amendments, if any, up to time of receipt of tender by Corporation issued by the Bureau of Indian Standards as referred to in the specifications and/ or work orders.
- h) The 'Contract Sum' means the sum agreed, or the sum calculated in accordance with the prices accepted by the NSIC in the tender and/ or the contract/ negotiated rates payable on completion of the works.
- i) The 'Final Sum' means the amount payable under the Contract by the Corporation to the Contractor for the full and entire execution and completion of works, in time.
- j) The 'Date of Completion' is the date/ date(s) for completion of the whole works, set out in the tender documents, or any subsequently amended by the Corporation.

- k) A 'Week' means seven days without regard to the number of hours worked or not worked in any day in a week.
- l) 'Excepted Risks' are risks due to riots (otherwise than among contractor's employees) and civil commotion (in so far as both these are uninsurable) war (whether declared or not), invasion act of foreign enemies, hostilities civil war, rebellion, revolution, insurrection military or usurped power, Acts of God, such as earthquake, lightening, unprecedented floods and other causes over which the contractor has no control and accepted as such by the Competent Authority or causes solely due to use or occupation by the 'Corporation' of the part of works in respect of which a certificate of completion has been issued.
- m) 'Urgent works' shall mean any urgent measures which in the opinion of the Engineer-in-charge, become necessary during the progress of the work to obviate any risk or accident or failure or which become necessary for security.
- n) The 'Works' shall mean the works to be executed in accordance with the contract or part(s) thereof as the case may be and shall include all extra or additional, altered or instituted works or temporary and urgent works as required for performance of the contract.

4. Works to be carried out:

The work to be carried out under the Contract shall, except as otherwise provided in these conditions, include all labour, materials, tools, plant, equipment and transport which may be required in preparation of and for and in the full and entire execution and completion of the works. The descriptions given in the Schedule of Quantities shall, unless otherwise stated, be held, to include wastage on materials, carriage and cartage, carrying in return of empties hoisting, setting, fitting and fixing in position and all other labour necessary in and for the full and entire execution and completion as aforesaid in accordance with good practice and recognized principles.

5. Inspection of Site:

The Contractor shall inspect and examine the Site and its surrounding and shall satisfy himself before submitting his tender as to the nature of the ground and subsoil (so far as is practicable), the form and nature of the Site, the quantities and nature of works and material necessary for the completion of the Works and the means of access to the Site, the accommodation he may require and in general shall himself obtain all necessary information as to risks, contingencies and other circumstances which may influence or affect this tender. No extra charges consequent on any misunderstanding or otherwise shall be allowed.

6. Sufficiency of Tender:

The Contractor shall be deemed to have satisfied himself before tendering as to the correctness and sufficiency of his tender for the works and of the rates and prices quoted in the Schedule of Quantities, which except as otherwise provided, cover all his obligations under the contract and all matters and things necessary for the proper completion and maintenance of the Works.

7. Discrepancies and Adjustment of Errors:

The several documents forming the contract are to be taken as mutually explanatory of one another:

7.1 (A) In the case of discrepancy between Schedules of quantities, Specifications and/ or the Drawings, the following order of preference shall be observed.

- a. Agreement
- b. Letter of Award
- c. Amendment/ Corrigendum to the tender document
- d. Schedule of Quantities (Price Bid)
- e. Tender Drawings (indicative)
- f. Notice Inviting Tender and Instruction to Tenderers
- g. Special conditions of Contract
- h. General Condition of Contract (GCC)

7.1 (B) If there are varying or conflicting provisions made in any document forming part of the Contract, the Accepting Authority shall be the deciding authority with regard to the intention of the document.

7.2 Any error in description, quantity or rate in Schedule of Quantities or any omission there from shall not vitiate the Contract or release the Contractor from the execution of the whole or any part of the Works comprised therein according to tender drawings and specifications or from any of his obligations under the Contract.

7.3 In case of Percentage Rate Tenders, contractor shall fill up the Schedule of Quantities/ Bill of Quantity, stating at what percentage below/ above (in figures as well as in words) the total estimated cost given in Bill of Quantity/ Price Bid, he will be willing to execute the work. The tender submitted shall be treated as invalid if:

- I. The contractor does not quote percentage above/ below on the total amount of tender or any section/ sub head of the tender.
- II. The percentage above/ below is not quoted in figures & words both on the total amount of tender or any section/ sub head of the tender.
- III. The percentage quoted above/ below is different in figures & words on the total amount of tender or any section/ sub head of the tender.

Tenders, which propose any alteration in the work specified in the said form of invitation to tender, or in the time allowed for carrying out the work, or which contain any other conditions of any sort including conditional rebates, will be summarily rejected.

7.4 In case the lowest tendered amount (estimated cost + amount worked on the basis of percentage above/ below) of two or more contractors is same, such lowest contractors will be asked to submit sealed revised offer in the form of letter mentioning percentage above/ below on estimated cost of tender including all sub sections/ sub heads as the case may be, but the revised percentage quoted above/ below on tendered cost or on each sub section/ sub head should not be higher than the percentage quoted at the time of submission of tender. The lowest tender shall be decided on the basis of revised offers.

In case any of such contractor refuses to submit revised offer, then their earlier submitted price bid shall be taken into consideration.

If the revised tendered amount of two more contractors received in revised offer is again found to be equal, the successful Tenderer among such contractors, shall be decided by Tenderer having highest average turnover in last seven (7) years.

In case all the lowest contractors those have quoted same tendered amount, refuse to submit revised offers, the successful Tenderer among such contractors, shall be decided by Tenderer having highest average turnover in last seven (7) years.

- 7.5** The NSIC shall open tenders in the presence of contractors who wish to be present at the time of tender opening.
- 7.6** The NSIC shall have the right of rejecting all or any of the tenders and will not be bound to accept the lowest or any other tender.
- 7.7** In case of Percentage Rate Tenders, only percentage below/ above quoted shall be considered. Any tender containing item rates is liable to be rejected. Percentage below/ above quoted by the contractor in percentage rate tender shall be accurately filled in figures and in words, so that there is no discrepancy.
- 7.8** In Percentage Rate Tender, the Tenderer shall quote percentage below/ above (in figures as well as in words) at which he will be willing to execute the subject work. He shall also work out the total amount of his offered price and the same should be written in figures as well as in words in such a way that no interpolation is possible. eg Percentage (-) 30.13% (in figures) shall be written in words as (-) Thirty point One three in the price bid.

The total worked out amount shall also be clearly written in price bid applying premium or discount (as the case be) (see page 44), which will provide Offered price value in explicit terms.

8. Performance Security:

Contractor will deposit performance security @ three percent (3%) of the accepted tender cost/ awarded cost as performance security within ten days (10) days from issuance of the letter of award by NSIC. The performance security is to be deposited by the contractor in the form of Demand Draft/ Banker's Cheque/ Pay Order favoring "The National Small Industries Corporation Ltd." payable at New Delhi.

The performance security shall remain with NSIC for a period of 60 (sixty) days beyond the date of completion of all contractual obligations of the contractor, including Defects Liability Period (DLP). The performance security will be forfeited and credited to the NSIC's account in the event of a breach of contract by the contractor/ termination of contract under any clause(s) of the contract. On expiry of a period of 60 days beyond the Defects Liability Period, the Engineer-In-Charge shall, on demand from the Contractor, refund to him the performance security (without any interest) provided the Engineer-in-Charge is satisfied that there is no demand outstanding against the Contractor.

9. Security Deposit

Security Deposit shall be deducted from gross amount of each running bill of the contractor @ five per cent (5 %) till the overall deducted security deposit (including earnest money deposit) reaches five percent (5%) of the accepted tender cost/ awarded cost. The earnest money deposit shall form part of security deposit.

9.1 Refund of Security deposit: The security deposit of 5% deducted from the each running bill of the contractor shall be refunded along with payment of final bill after successful completion of the work in all respect.

9.2 No interest shall be payable to the contractor against the Security Deposit furnished/ recovered from the contractor, by the Corporation under any circumstance whatsoever. The security deposit will be forfeited and credited to the NSIC's account in the event of a breach of contract by the contractor/ termination of contract under any clause(s) of the contract.

10. Deviations/ Variations Extent & Pricing:

10.1 The contract awarding personnel shall have power (i) to make alteration in, omissions, from or additions to, or substitutions from the original specification, drawings, designs and instructions that may appear to him to be necessary or advisable during the progress of the work, and (ii) to omit a part of the works in case of non-availability of a portion of the Site or for any other reasons, and the Contractor shall be bound to carry out the Works in accordance with any instructions given to him in writing signed by The Engineer-in-Charge and such alterations, omissions, additions or substitutions shall form part of the Contract as if originally provided therein and any altered, additional or substituted work which the contractor may be carrying out on the same conditions in all respects including price on which he agreed to do the main work. Any alterations, omissions additions or substitutions ordered by the Engineer-In-Charge which in the opinion of the contractor changes the original nature of the Contract, he shall carry it out and the rates for such additional, altered or substituted work shall be determined by the Engineer-in-Charge as per clause 10 (i) to (iii) here under of the tender document.

10.2 The time of completion of the works shall in the event of any deviations resulting in additional cost over the Contract Sum being ordered be extended as follows if requested by the Contractor.

- In the proportion which the additional cost of the altered additional or substituted work, bears to the original Contract sum; plus.
- 25% of the time calculated in (a) above or such further additional time as may be considered reasonable by the Engineer-in-Charge.

11. Rates for Extra/ Additional Items

- If the rate for additional, altered or substituted item of work specified in the Schedule of Quantities the Contractor shall carry out the additional, altered or substituted item at the same rate.
- If the rate for any altered, additional or substituted item of work is not specified in the schedule of Quantities the rate for that item shall be derived from the rate for the nearest similar item specified therein.
- If the rate for any altered, additional or substituted item of work cannot be determined in the manner specified in sub-paras (i) and (ii) above, the contractor shall within 7 days of the receipt of the order to carry out the said work, inform the Engineer-in-Charge under advice to the Accepting Authority of the rate which he proposes to claim for such item of work, supported by analysis of the rate claimed, and the Engineer-in-Charge shall, within One month thereafter, after give due consideration to the rate claimed by the Contractor determine the rate on the basis of market rate(s). In the event of the contractor failing to inform the Engineer-in-Charge within the stipulated period of time, the rate which he proposes to claim, the rate for such item shall be determined by the Engineer-in Charge on the basis of market rate(s) and shall be final.

12. Suspension of Works:

- a) The contractor shall, on receipt of the order in writing of the Engineer-in-Charge, or consequent upon issuance of guidelines/ orders by any statutory authority for stoppage/ suspension of work, suspend the progress of the works or any part thereof for such time and in such manner as the Engineer-in-Charge may consider necessary for any of the following reasons:
 - i) On account of any default on part of the Contractor; or
 - ii) For proper execution of the Works or part thereof for reasons other than the default of the Contractor including stoppage/ suspension of works order by any statutory authority; or
 - iii) For safety of the works or part thereof. The contractor shall, during such suspension, properly protect and secure the works to the extent necessary and carry out the instructions given in that behalf by the Engineer-in-Charge.
- b) If the suspension is ordered for reasons (ii) and (iii) in sub-para (a) above. The Contractor shall be entitled to an extension of the time equal to the period of every such suspension plus 25%. No financial compensation for such suspension shall be admissible to the contractor.

13. Time and Extension for Delay:

The time allowed for execution of the works as specified in the Appendix or the extended time as approved by NSIC in accordance with these conditions shall be the essence of the Contract. The execution of the works shall commence from the 10th day after the date on which the Corporation issues written orders to commence the work or from the date of handing over of the site, whichever is earlier. If the Contractor commits default in commencing the execution of the work as aforesaid, Corporation shall without prejudice to any other right or remedy be at liberty to terminate the contract and also to debar the contractor for a period of three years from participating in any tender invited by the Corporation.

13.1 As soon as possible after the Contract is concluded the Engineer-in-Charge and the Contractor shall agree upon a Time and Progress Chart. The Chart shall be prepared in direct relation to the time stated in the Contract documents for completion of items of the works. It shall indicate the forecast of the dates of commencement and completion of various trades or sections of the work and may be amended as necessary by agreement between the Engineer-in-Charge and the Contractor within the limitations of time imposed in the Contract Documents.

13.2 If the work be delayed by

- (a) Force majeure or
- (b) Abnormally bad weather or
- (c) Serious loss or damage by fire, or
- (d) Civil commotion, local combination of workmen strike or lockout, affecting any of the trades employed on the work, or
- (e) Delay on the part of other contractors or tradesmen engaged by Corporation in executing work not forming part of the contract, or
- (f) Any other cause which, in the absolute discretion of the authority mentioned in Appendix is beyond the Contractor's control;

Then upon the happening of any such event causing delay, the Contractor shall immediately give notice thereof in writing to the Engineer-in-Charge but shall nevertheless use constantly his best endeavors to prevent or make good the delay and shall do all that may be reasonably required to the satisfaction of the Engineer-in-Charge to proceed with the Works.

13.3 Request for extension of time, to be eligible for consideration, shall be made by the Contractor in writing within fourteen days of the happening of the event causing delay. The Contractor may also if practicable, indicate in such request the period for which extension is desired.

13.4 In any such case the competent authority may give a fair and reasonable extension of time for completion of the work. Such extension shall be communicated to the contractor by the Engineer-in-Charge and no compensation whatsoever for the extended period, if any shall be applicable/ payable.

14. The Contractor shall arrange, at his own expense, all tools, plant and equipment hereafter referred to as (T&P) labour, P.O.L. & electricity required for execution of the work.

15. FORCE MAJEURE

Any delays in or failure of the performance of either party herein shall not constitute default hereunder or give rise to any claim for damages, if any, to the extent such delays or failure of performance is caused by occurrences such as Act of god or the public enemy, expropriation or confiscation of facilities by Government authorities, or in compliance with any order or request of any Governmental authorities or due acts of war, rebellion or sabotage or fires, floods, explosions, riots or illegal joint strikes of all the workers of all the contractors.

16. MATERIALS

1. All materials to be provided by the Contractor shall be in conformity with the specifications laid down in the contract and the Contractor shall, if requested by the Engineer-in-Charge, furnish proof to the satisfaction of Engineer-in-Charge in this regard.
2. The contractor shall indemnify the Corporation, its representatives or employees against any action, claim or proceeding relating to infringement or use of any patent or design or any alleged patent or design rights and shall pay any royalties or other charges which may be payable in respect of any article or material or part thereof included in the Contract. In the event of any claim being made or action being brought against the Corporation or any agent, servant or employee of the Corporation in respect of any such matters as aforesaid, the Contractor shall immediately be notified thereof.
3. All charges on account of octroi, terminal or GST and other duties on material obtained for the Works from any source shall be borne by the Contractor.
4. The Engineer-in-Charge shall be entitled to have tests carried out as specified as per relevant standard code of practice for any materials supplied by the Contractor even for those for which, as stated above, satisfactory proof has already been furnished, at the cost of the Contractor and the Contractor shall provide at his own expense all test facilities which the Engineer-in-Charge may require for the purpose. The cost of materials consumed in tests shall be borne by the Contractor.
5. Stores and Materials required for the works, brought by the Contractor, shall be stored by the Contractor only at places approved by the Engineer-in-Charge. Storage and safe custody of material shall be the responsibility of the contractor.

- i. Corporation's officials concerned with the Contract shall be entitled at any time to inspect and examine any materials intended to be used in or on the works, either on the Site or at factory or workshop or other place(s) where such materials are assembled, fabricated or at any place(s) where these are lying or from where these are being procured and the contractor shall give such facilities as may be required for such inspection and examination.
- ii. All materials brought to the Site shall become and remain the property of the Corporation and shall not be removed off the Site without the prior written approval of Engineer-in-Charge of the Corporation. But whenever the works are finally completed the Contractor shall, at his own expense forthwith, but with the prior approval from the Corporation, remove from the Site all surplus materials originally supplied by him and upon such removal the same shall revert in and become the property of the contractor. However before giving any approval as aforesaid, the corporation shall be entitled to recover or adjust any amount given as advance to the Contractor.

17. Labour laws and payment of wages to be complied:

The contractor shall comply with the labour laws in force. No labour below the age of eighteen years shall be employed on the works. The Tenderer should make their own arrangement for the assign all labour trained in the particular field of work preferably local.

The contractor shall obtain a valid license under the Contract Labour (R&A) Act, 1970 and the Contract Labour (R&A) Central Rules, 1971, before the commencement of the work, and continue to have a valid license till completion of work. The contractor shall also abide by the provisions of the Child Labour (Prohibition and Regulation) Act, 1986. The contractor shall comply with the provisions of the Payments of wages act, 1936, Minimum wages Act, 1948, Employment liability Act, 1938, Workmen's compensation act 1923, Industrial dispute Act, 1947, the factories act 1948, maternity benefit act 1961 and any statutory amendments or re- amendments thereof for the time being in force.

In respect of all laborers directly or indirectly employed in the work for the performance of the contractor's part of this contract, the contractor shall at his own expense arrange the safety provision as per safety code framed from time to time by statutory authorities and shall at his own expense provide for all facilities in connection therewith. In case, the contractor fails to make arrangement and provide necessary facilities as aforesaid he shall be responsible for any compensation for each default and in addition the Engineer-In-Charge shall be at liberty to make arrangement and provide facilities as aforesaid and recover the costs incurred in that behalf from the contractor.

The contractor shall be fully liable for compliance of EPF or ESI of the labours/ workmen deployed by them for carrying out the work as per prevailing Central or State government norms and the Corporation has nothing to do with the same. Corporation shall not be responsible for any liability/ claims whatsoever in this regard. Further as and when demanded by the Corporation, the contractor shall submit the proof of deductions/ deposits of such liabilities of their labors/ workmen engaged in the work to the Corporation. In case of default, the Corporation may deduct the payments against these liabilities from the bills of the contractor or may stop the payment of the bill till such time the compliance is provided by the contractor.

The ESI and EPF contributions on the part of employer in respect of this contract shall be paid by the contractor. These contributions on the part of the employer paid by the contractor shall be reimbursed by the Engineer-in-charge to the contractor on actual basis, as applicable subject to submission of necessary supporting documents by the contractor to the satisfaction of the Engineer-in-Charge.

18. Liquidated Damages for Delay

18.1 Time is essence of the contract. In case the CONTRACTOR fails to complete the whole work within the stipulated period, and clear the site, he shall be liable to pay liquidated damages @ 0.5% (Half percent only) of the value of contract per week and or part thereof of the delay subject to a maximum of 10% (ten percent only) of the value of the contract. The parties agree that this is a genuine pre-estimate loss/ damage which will be suffered on account of delay on the part of the Contractor and the said amount will be payable on demand without there being any proof of the actual loss of damages caused by such delay.

18.2 The amount of Compensation may be adjusted or set-off against any sum payable to the Contractor under this or any other contract with the Corporation.

19. Defects Liability Period:

The Contractor shall be responsible to make good and remedy at his own expense within defect liability period of one year from the date of completion of the work in all respect.

20. Contractor's Liability and Insurance

From commencement to completion of the works, the Contractor shall take full responsibility, care of and precautions to prevent loss or damage and to minimize loss or damage to the greatest extent possible and shall be liable for any damage or loss that may happen to the Works or any part thereof from any cause whatsoever (save and except the Excepted Risks) and shall at his own cost repair and make good the same so that, at completion, the works shall be in good order and conditions and in conformity in every respect with the requirements of the Contract and instructions of the Engineer-in-Charge.

20.1 In the event of any loss or damage to the Works or any part thereof or to any material or articles at the Site from any of the Excepted Risks the following provisions shall have effect:

- a. The Contractor shall, as may be directed in writing by the Engineer-in-Charge, remove from the site any debris and so much of the works as shall have been damaged.
- b. The Contractor shall, as may be directed in writing by the Engineer-in-Charge, proceed with the completion of the works under and in accordance with the provisions and Conditions of the Contract, and

20.2 Provided always that the Contractor shall not be entitled to payment under the above provisions in respect of such loss or damage as has been occasioned by any failure on his part to perform his obligations under the Contract or not taking precautions to prevent loss or damage or minimize the amount of such loss or damage.

20.3 The Contractor shall indemnify and keep indemnified the Corporation against all losses and claims for injuries or damage to any persons or any property whatsoever which may arise out of or in consequence of the construction and maintenance of works and against all claims, demands proceedings, damages costs, charges and expenses whatsoever in respect of or in relation thereto. Provided always that nothing herein contained shall be deemed to render the Contractor not liable

for or in respect of or to indemnify the Corporation against any compensation or damage caused by the Excepted Risks.

- 20.4** Before commencing execution of the work, the Contractor shall, without in any way limiting his obligations and responsibilities under this condition, obtain and deposit with the Corporation-**“Contractors All Risk Policy”** and **“Third Party”** Insurance policy.
- 20.5** The Contractor shall at all times indemnify the Corporation against all claims, damages or compensation under the provisions of Payment of Wages Act, 1936, Minimum Wages Act. 1948, Employer’s Liability Act, 1938 the Workmen’s Compensation Act, 1923, Industrial Disputes Act, 1947 and the Maternity Benefit Act. 1961 or any modifications thereof or any other law relating thereto and rules made thereunder from time to time.
- 20.6** The Contractor shall provide copies of Insurance policies to the Engineer-in-Charge from time to time to prove that he has taken all the insurance policies referred to above and has paid the necessary premiums for keeping the policies alive till completion of the work.
- 20.7** All statutory deductions as applicable like TDS, Works Contract Tax Act etc shall be made from the due payment of the contractor.
- 20.8** No claim for interest will be entertained by the corporation in respect of any balance payments or any deposits which may be held up with the corporation due to any dispute between the corporation and contractor or in respect of any delay on the part of the corporation in making final payment or otherwise.
- 20.9** The contractor shall ensure that no materials/ wastes/ plant, equipment etc. are dumped at the site. In case any of the above items are dumped, the contractor shall clear the same from the site by or before completion of the work at his own cost or otherwise NSIC shall clear the same work at the contractor’s risk and cost after serving 7 days’ notice.
- 20.10** The contractor will have to make their own arrangement for facilitating movement of labour to work site and back. Facilities are to be provided to labourers as per statutory provision and the same shall not entail or attract any extra cost to NSIC.

21. Safety Code:

- 21.1** The Contractor shall at his own expense arrange for the safety provisions as appended to these conditions or as required by the Engineer-in-Charge, in respect of all labour directly or indirectly employed for performance of the works and shall provide all facilities in connection therewith. In case the Contractor fails to make arrangements and provide necessary facilities as aforesaid the Engineer-in-Charge shall be entitled to do so and recover cost thereof from the Contractor.
- 21.2** The contractor shall provide and maintain at his own expenses guards, fencing and hatching when and where necessary or required by the Engineer-in-Charge for the protection of the works or for the safety and convenience of those employed on the works or the public.
- 21.3** The corporation shall not be liable for any accident, injury or for any other mishap caused to him/ them/ their employees/ agents and labour employed by the contractor and for any kind of damage to the works during the execution of the contract or work done. For any kind of such injury or loss caused to any person/ persons mentioned herein above or damages to the work, the contractor shall be exclusively liable.

22. Cancellation/ Termination of Contract in Full or in Part:

22.1 If the Contractor:

- a. At any time makes defaults in proceeding with the Works with due negligence and continues to do so even after a notice in writing of 7 days from the Engineer-in-Charge; or
- b. Commits default in complying with any of the terms and conditions of Contract and does not remedy it or take effective steps to remedy it within 7 days after a notice in writing is given to him in that behalf by the Engineer-in-Charge; or
- c. Fails to complete the works or items of work on or before the date(s) of completion, and does not complete them within the period specified in a notice given in writing in that behalf by the Engineer-in-Charge; or
- d. Enters into a contract with the Corporation in connection with which commission has been paid to any person(s) or agreed to be paid by him or to his knowledge, unless the particulars of any such commission and the term of payment have previously been disclosed in writing to the Accepting Authority/Engineer-in-Charge; or
- e. Offers or gives or agrees to give to any person in Corporation's service or to any other person on his behalf any gift or consideration of any kind as an inducement or reward for doing or for bearing to do or having done any act in relation to the abstention or execution of this or any other Contract for the Corporation or
- f. Obtains a Contract with the Corporation as a result of ring tendering or other non-bonafide methods of competitive tendering; or
- g. Being an individual or any of its partner (in case of the Contractor is a partnership firm) at any time is adjudged insolvent or have a receiving order or order for administration of his estate made against him or shall take any proceedings for liquidation or composition (other than a voluntary liquidation for the purpose of amalgamation or reconstruction) under any insolvency Act for the time being in force or make any conveyance or assignment of his affective or composition or arrangement of the benefit of his creditors or purport so to do, or if any application be made under any insolvency Act for the time being in force for the sequestration of his estate or if a trust deed be executed by him for benefit of his creditors; or
- h. Being a company, passes a resolution or the Court makes an order for liquidation of its affairs, or a receiver or manager on behalf of the debenture holders is appointed or circumstances shall arise which entitle the Court or debenture holders to appoint a receiver or manager; or
- i. Assigns, transfers sublets (engagement of labour on a piece-work basis or of labour with materials not be incorporated in the work shall not be deemed to be subletting) or attempts or assign, transfer or sublet the entire works or any portion thereof without the prior written approval of the Accepting Authority.

22.2 The Competent Authority may, without prejudice to any other right or remedy which shall have accrued or shall accrue thereafter to the Corporation by written notice cancel/ terminate the contract as a whole or in part as it may deem appropriate.

22.3 The Competent Authority shall on such cancellation/ termination, be entitled to:

- a. Take possession of the site and any materials, construction plant, implements, stores, etc., thereon; and/ or
- b. Carry out the incomplete work by any means at the risk and cost of the Contractor.

- 22.4** On cancellation/ termination of the Contract, in full or in part, the Accepting Authority shall determine the quantum of amount, if any, recoverable from the Contractor for completion of Works or part of the works or in case the works or part of the works is not completed, the loss or damage suffered by the Corporation. In determining the amount credit shall be given to the Contractor for the value of the work, if any, executed by him up to the time of cancellation of the contract, the value of contractors material taken over and incorporated in the work and use of tools & tackle and machinery belonging to the Contractor.
- 22.5** Any excess expenditure incurred or to be incurred by the Corporation in completing the Works or part of the Works or the excess loss or damages suffered or may be suffered by the Corporation as aforesaid after allowing such credit shall be recovered from any money due to the Contractor or any account, and if such money is not sufficient the Contractor shall be called upon in writing to pay the same within 30 days.
- 22.6** If the Contractor shall fail to pay the required sum within the aforesaid period of 30 days, the Engineer-in-Charge shall have the right to sell any or all of the Contractor's unused materials, constructional plant, implements, temporary buildings, etc. and apply the proceeds of sale thereof towards the satisfaction of any sums due from the Contractor under the contract and if thereafter there be any balance outstanding from the Contractor, it shall be recovered in accordance with the provisions of the Contract.
- 22.7** Any sums in excess of the amounts due to the Corporation on unsold materials, constructional plant, etc. shall be returned to the Contractor, provided always that if cost or anticipated cost of the completion by the Corporation of the works or part of the works is less than the amount which the Contractor would have been paid had he completed the works or part of the works such benefit shall not accrue to the Contractor.

23. Liability for Damage, Defects or Imperfections and Rectification thereof:

- 23.1** If the Contractor or his workmen or employees shall injure or destroy any part of the building in which they may be working or any building, road, fence etc, continuous to the premises on which the work or any part of it is being executed, or if any damage shall happen to the work while in progress the Contractor shall upon receipt of a notice in writing from Engineer-in-charge in that behalf, make the same good at his own expense. If it shall appear to the Engineer-in-Charge or his Representative at any time during construction or re-construction or prior to the expiration of Defects Liability Period, that any work has been executed with unsound, imperfect or unskilled workmanship or that any materials or articles provided by the Contractor, the contractor shall, upon receipt of a notice in writing in that behalf from the Engineer-in-Charge, forthwith rectify or remove and reconstruct the work so specified in whole or in part, as the case may require or as the case may be, and/ or remove the materials or articles at his own expense, notwithstanding that same may have been inadvertently passed, certified and paid for and in the event of non-compliance his notice aforesaid, the Engineer-in-Charge may rectify or remove and re-execute the work and/ or remove and replace with others the materials or articles complained of as the case may be, by other means at the risk and expense of the Contractor.
- 23.2** In case of repairs and maintenance works, splashes and dropping from white washing, painting, etc. shall be removed and surfaces cleaned simultaneously with completion of these items of work in

individual rooms, quarters or premises, etc. where the work is done, without waiting for completion of all other items of work in the contract. In case the Contractor fails to comply with the requirements of this condition, the Engineer-in-Charge shall have the right to get the work done by other means at the cost of the Contractor. Before taking such action, however, the Engineer-in-Charge shall give three days' notice in writing to the Contractor.

24. Urgent Works:

If any Urgent work (in respect whereof the decision of the Engineer-in-Charge shall be final and binding) becomes necessary and Contractor is unable or unwilling at once to carry it out, the Engineer-in-Charge may by his own or other workpeople carry it out, as he may consider necessary. If the urgent work shall be such as the Contractor is liable under the contract to carry out at his expenses incurred on it by the Corporation shall be recoverable from the Contractor and be adjusted or set off against any sum payable to him.

25. PAYMENTS:

25.1 Payment shall be released as per the quantum of work executed in accordance to the instruction and drawings issued to the contractor. Any work executed by the contractor in violation to the tender specifications, drawings and direction of Engineer in charge shall constitute breach of agreement and shall not qualify for the measurement and payment. Payment shall be made only for the actual amount of work carried out as per BOQ (on pro-rata only). The measurement shall be jointly recorded by the contractor and representative of NSIC. If Contractor intends to submit interim R.A Bills, these should not be less than Rs 7.50 Lakh value of work executed. All other statutory deductions and Security deposit as applicable shall be effected from each running bills.

25.2 No price escalation will be paid even in extended period, if any.

25.3 All statutory deductions as applicable like TDS, and other taxes as applicable shall be made from the due payment of the contractor.

26. MOBILISATION ADVANCE: No mobilization advance whatsoever shall be paid for carrying out this work.

27. Without prejudice to any of the rights or remedies under this contract, if the contractor dies, the legal heirs of contractor shall be given opportunity to complete the remaining work, failing which NSIC shall have the option of fore-closing the contract with making payment due to the contractor for work (partly) completed (as per measurement) (for which legal heirs shall submit affidavit for amount acceptance and no further claim on NSIC) but without any compensation to the contractor.

28. ARBITRATION:-

28.1 All questions and disputes relating to the meaning of the words, terms, specifications, operations, and instructions, mentioned in this contract and as to the quality of workmanship or performance of the contractor any other question, claim, right, matter, or thing whatsoever in any way arising out of correlating to the contract, specifications, operating instructions, orders or these conditions; or otherwise concerning the performance of the contract, the execution or failure to execute the same whether arising during the existence of the contract or after the termination of the contract, the same shall be referred to the sole arbitrator to be appointed by the Chairman-Cum-Managing Director of the Corporation.

- 28.2** The Arbitrator shall have power to call for such evidence by way of affidavits or otherwise as he thinks proper and it shall be the duty of the parties hereto to do or cause to be done, all such things as may be necessary to enable the Arbitrator to make the award without any delay. The Arbitrator shall give a separate award in respect of each dispute or difference referred to him. The venue of arbitration shall be at New Delhi. The Award of the Arbitrator shall be final, conclusive and binding on all parties to the contract
- 28.3** The law under the Arbitration and Conciliation Act, 1996 as amended by the Arbitration and Conciliation (Amendment) Act 2015 shall be applicable to such proceedings and also for selection of sole Arbitrator.
- 28.4** The cost of arbitration shall be borne by the parties to the dispute, as may be decided by the arbitrator(s).
- 28.4** The Courts in the city of New Delhi shall have the exclusive jurisdiction to entertain any application or other proceedings in respect of any disputes arising under this agreement and any award or awards made by the Arbitrator here-in-before can be challenged in the concerned Courts in the aforesaid city only.

**Deputy General Manager
Contract & Procurement Cell,
NSIC Limited
Okhla, New Delhi**

SIGNATURE OF THE CONTRACTOR



FORM OF TENDER-CUM-BID SECURITY DECLARATION

To,
The CGM-SG (MIS),
The National Small Industries Corporation Ltd., Okhla Industrial Estate,
New Delhi-110020

I/ We have read and examined the following documents relating to _____
_____ **Name of the Work)**

- (a) Notice inviting tender.
- (b) Instructions to Tenderers
- (c) Technical Specifications
- (d) General Conditions of Contract including Contractors, Labour Regulations, Model Rules for Labour Welfare and Safety Code appended to these conditions together with the amendments thereto if any.
- (e) Special Conditions of contracts.
- (f) Schedule of Quantities/ Price Bid
- (g) Corrigendum/ Addendum, if any

I/We hereby tender for execution of the works referred to in the aforesaid documents upon the terms and conditions contained or referred to therein and in accordance in all respects with the specifications, designs, drawings and other relevant details at the rates contained in Schedule and within the period(s) of completion as stipulated in Appendix.

In consideration of I/ We being invited to tender, I/We agree to keep the tender open for acceptance for 120 days from the due date of submission thereof and not to make any modifications in its terms and conditions which are not acceptable to the Corporation.

A sum of Rs. 75,760/- is hereby forwarded as Earnest Money Deposit in the form of Demand Draft/ Banker's Cheque in favour of "The National Small Industries Corporation Ltd" payable at New Delhi.

If I/ We fail to keep the tender open as aforesaid or make any modifications in the terms and conditions of the tender which are not acceptable to the Corporation, I/We agree that the Corporation shall without prejudice to any other right or remedy, be at liberty to forfeit the said earnest money absolutely and reject the tender.

Should this tender be accepted, I/ We agree to abide by & fulfill all the terms conditions of aforesaid document.

If after the tender is accepted, I/ we fail to commence the execution of the work as provided in the conditions. I/ We agree that Corporation shall without prejudice to any other right or remedy is at liberty to forfeit the said earnest money absolutely and reject the tender.

Signature of Bidder _____

Duly authorized to sign the tender

Dated _____

Witness _____

Date _____

Address _____

APPENDIX

1. Competent Authority : C.M.D. NSIC or his Authorized executives
2. Earnest money/Security deposit
 - a. Estimated cost of the Works; : Rs. 37.88 Lakhs (excluding GST)
 - b. Earnest money : Rs. 75,760/-
 - c. Performance Security : 3%
 - d. Security Deposit : 5%
3. Time allowed for execution of work : 120 days
4. Authority competent to decide if “any other cause” of delay is beyond contractors control : CMD, NSIC or his authorized representative
5. Liquidated Damaged : 0.5% (half percent) per week subject to a Maximum 10% value of the contract
6. Defect Liability Period : 12 months from the date of Completion of work in all Respect
7. Authority competent to reduce compensation : CMD NSIC or his authorized executive

SPECIAL CONDITIONS OF CONTRACT

1. During working at site, some restrictions may be imposed by Engineer-in-Charge/ Security staff of Corporation or Local Authorities regarding safety and security etc., the contractor shall be bound to follow all such restrictions/ instruction & nothing extra shall be payable on this account.
2. No compensation shall be payable to the contractor for any damage caused by rains lightening, wind, storm, floods Tornado, earth quakes or other natural calamities during the execution of work. He shall make good all such damages at his own cost; and no claim on this account will be entertained.
3. No labour hutment shall be allowed in the premises. All labourers should leave the site after day's work. The security & Watch ward for safeguarding the contractor's materials/ work etc. shall be arranged at his cost only.
4. The percentage tender premium or discount quoted by the Bidders shall remain firm for the contract period/extended contract period (if any).
5. If the contractor fails to proceed with the work within the stipulated time as specified from the date of issue of letter of intent/letter to proceed with the work, the Corporation shall reject the award of the work and the contractor shall be debarred from participating in any tender invited by the Corporation for a period of three years.
6. **Execution of Work at Risk & Cost of Contractor:**
The balance work, if any, left to be completed after the determination/ cancellation of the contract as per clause no. 21 of the 'General Conditions of Contract' shall be got executed by the Corporation as stipulated in the said clause at the risk and cost of the contractor and the additional expenditure, if any, incurred by the Corporation in getting the work executed in the manner stated above, the same shall be recovered from the dues of contractor. In case the dues of the contractor are not sufficient, the contractor shall be liable to deposit the excess amount incurred by the Corporation as communicated by the Engineer-in-charge within 30 days of written notice.
7. The work shall be executed in accordance with the latest CPWD specification mentioned in the Schedule of quantity and in case of any discrepancy the CPWD specifications with latest amendments if any, shall be followed. The decision of the Engineer-In-Charge in this regard shall be final and binding upon the contractor.
8. The materials used for carrying out the work shall be of best available quality and the contractor has to carry out the necessary testing as per CPWD specification for its conformity with specifications and all testing charges shall be borne by the contractor.
9. All the civil works, if required, like fixing of load hooks, making chases in the wall, drilling of holes, fixing of doors and finishing of jambs, providing scaffolding for carrying out complete works shall be arranged by the contractor and making good the damages. Nothing extra on these account shall be considered or paid.
10. The debris/ scrap generated during the course of execution of work shall be safely disposed off by the contractor outside of the NSIC, Okhla complex or as directed by the Engineer-In-Charge. Nothing extra shall be paid to the contractor on this account.



11. The contractor shall be fully responsible for the any injury or damage caused to the workmen deployed by him at site for carrying out the work and Corporation has nothing to do with such happenings and in no way shall be held responsible for the same.
12. The Tenderer shall quote the rate(s) exclusive of GST. GST shall be released separately on submission of documentary proof of remittance of same.
13. Water & electricity, if required, shall be made available at site by NSIC for execution of work without any cost. However, the contractor shall make the necessary arrangement for extension of water/ power connection to the work site from the designated points, as per his requirement.
14. All clarification/ communication should be addressed to Deputy General Manager (C&P), The National Small Industries Corporation Ltd., Okhla Industrial Estate, New Delhi-110020 either through speed-post or email on procurement@nsic.co.in .

Signature of Bidder

INDICATIVE DRAWING

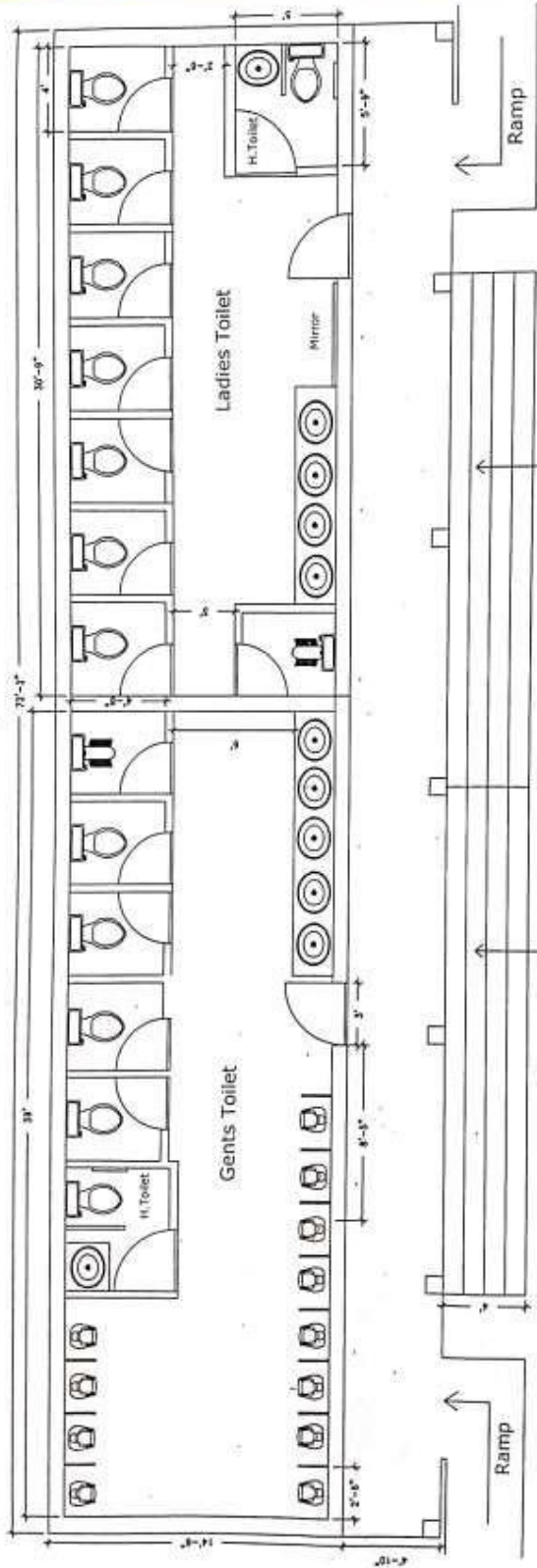

Toilet Block Layout For Exhibition Ground, Okhla,

BILL OF QUANTITIES (Price Bid)
(to be submitted separately in a sealed envelope)

S. No.	Description	Qty	Unit	Rate (Rs)	Amount (Rs)	DSR/ MR No.
A	Civil Works					
1	EARTH WORK					2
1.1	Earth work in excavation by mechanical means (Hydraulic excavator)/ manual means over areas (exceeding 30 cm in depth, 1.5 m in width as well as 10 sqm on plan) including getting out and disposal of excavated earth lead upto 50 m and lift upto 1.5 m, as directed by Engineer-in-charge.					2.6
1.1.1	All kinds of soil	40.85	cum	182.13	7440.07	2.6.1
1.2	Excavating trenches of required width for pipes, cables, etc including excavation for sockets, and dressing of sides, ramming of bottoms, depth upto 1.5 m, including getting out the excavated soil, and then returning the soil as required, in layers not exceeding 20 cm in depth, including consolidating each deposited layer by ramming, watering, etc. and disposing of surplus excavated soil as directed, within a lead of 50 m :					2.1
1.2.1	All kinds of soil					2.10.1
1.2.1.1	Pipes, cables etc. exceeding 80 mm dia. but not exceeding 300 mm dia	45	metre	369.98	16649.13	2.10.1.2
1.3	Filling available excavated earth (excluding rock) in trenches, plinth, sides of foundations etc. in layers not exceeding 20cm in depth, consolidating each deposited layer by ramming and watering, lead up to 50 m and lift upto 1.5 m.	12.55	cum	225.13	2825.34	2.25
1.4	Excavating, supplying and filling of local earth (including royalty) by mechanical transport upto a lead of 5km also including ramming and watering of the earth in layers not exceeding 20 cm in trenches, plinth, sides of foundation etc. complete.	30	cum	326.81	9804.25	2.25A
2	CONCRETE WORK					
2.1	Providing and laying in position cement concrete of specified grade excluding the cost of centering and shuttering - All work up to plinth level :					4.1
2.1.1	1:1½:3 (1 Cement: 1½ coarse sand (zone-III) derived from natural sources : 3 graded stone aggregate 20 mm nominal size derived from natural sources).	10.11	cum	6900.21	69761.08	4.1.2
2.1.2	1:4:8 (1 Cement: 4 coarse sand (zone-III) derived from natural sources : 8 graded stone aggregate 40 mm nominal size derived from natural sources).	23.44	cum	5608.04	131452.54	4.1.8
2.2	Providing and laying cement concrete in retaining walls, return walls, walls (any thickness) including attached pilasters, columns, piers, abutments, pillars, posts, struts, buttresses, string or lacing courses, parapets, coping, bed blocks, anchor blocks, plain window sills, fillets, sunken floor etc., up to floor five level, excluding the cost of centering, shuttering and finishing :					4.2
2.2.1	1:1½:3 (1 cement : 1½ coarse sand (zone-III) derived from natural sources : 3 graded stone aggregate 20 mm nominal size derived from natural sources).	0.92	cum	8682.16	7987.59	4.2.2
2.3	Centering and shuttering including strutting, propping etc. and removal of form work for :					4.3

2.3.1	Foundations, footings, bases for columns	36.36	sqm	273.00	9926.20	4.3.1
2.3.2	Retaining walls, return walls, walls (any thickness) including attached pilasters, buttresses, plinth and string courses fillets, kerbs and steps etc.	1.84	sqm	593.56	1092.14	4.3.2
2.4	Providing and laying damp-proof course 40 mm thick with cement concrete 1:2:4 (1 cement : 2 coarse sand derived from natural sources): 4 graded stone aggregate 12.5 mm nominal size derived from natural sources)	28.96	sqm	328.76	9520.85	4.10
2.5	Providing & applying a coat of residual petroleum bitumen of grade of VG-10 of approved quality using 1.7kg per square metre on damp proof course after cleaning the surface with brushes and finally with a piece of cloth lightly soaked in kerosene oil.	28.96	sqm	100.93	2922.88	4.13
2.6	Making plinth protection 50 mm thick of cement concrete 1:3:6 (1 cement: 3 coarse sand derived from natural sources: 6 graded stone aggregate 20 mm nominal size derived from natural sources) over 75 mm thick bed of dry brick ballast 40 mm nominal size, well rammed and consolidated and grouted with fine sand, including necessary excavation, levelling & dressing & Finishing the top smooth.	22.66	sqm	604.28	13693.05	4.17
3	REINFORCED CEMENT CONCRETE					5
3.1	Reinforced cement concrete work in walls (any thickness), including attached pilasters, buttresses, plinth and string courses, fillets, columns, pillars, piers, abutments, posts and struts etc. above plinth level up to floor five level, excluding cost of centering, shuttering, finishing and reinforcement					5.2
3.1.1	1:1.5:3 (1 cement: 1.5 coarse sand (zone-III) derived from natural sources: 3 graded stone aggregate 20 mm nominal size derived from natural sources).	5.59	cum	9029.05	50472.37	5.2.2
3.2	Centering and shuttering including strutting, propping etc. and removal of form for					5.9
3.2.1	Lintels, beams, plinth beams, girders, bressumers and cantilevers	62.08	sqm	539.30	33479.89	5.9.5
3.2.2	Edges of slabs and breaks in floors and walls					5.9.16
3.2.2.1	Under 20 cm wide	8.4	metre	161.25	1354.54	5.9.16.1
3.3	Steel reinforcement for R.C.C. work including straightening, cutting, bending, placing in position and binding all complete upto plinth level.					5.22
3.3.1	Thermo-Mechanically Treated bars of grade Fe-500D or more.	550	kg	79.47	43711.10	5.22.6
4	MASONRY WORK					6
4.1	Brick work with common burnt clay F.P.S. (non-modular) bricks of class designation 7.5 in foundation and plinth in:					6.1
4.1.1	Cement mortar 1:4 (1 cement : 4 coarse sand)	37.34	cum	6100.89	227807.34	6.1.1
4.2	Brick work with common burnt clay F.P.S. (non-modular) bricks of class designation 7.5 in superstructure above plinth level up to floor V level in all shapes and sizes in :					6.4
4.2.1	Cement mortar 1:4 (1 cement : 4 coarse sand)	46.91	cum	7545.98	353981.76	6.4.1
4.3	Half brick masonry with common Burnt clay F.P.S. (non modular) bricks of class designation 7.5 in superstructure above plinth level up to floor V level.					6.13
4.3.1	Cement mortar 1:3 (1 cement :3 coarse sand)	99.34	sqm	924.71	91860.51	6.13.1
4.4	Extra for providing and placing in position 2 Nos 6mm dia. M.S. bars at every third course of half brick masonry.	99.34	sqm	76.64	7613.21	6.15

4.5	Providing and laying autoclaved aerated cement blocks masonry with 100 mm thick AAC blocks in super structure above plinth level up to floor V level in cement mortar 1:4 (1 cement : 4 coarse sand). The rate includes providing and placing in position 2 Nos 6 mm dia M.S. bars at every third course of masonry work.	1.5	cum	7881.69	11822.54	6.38
5	CLADDING WORK					8
5.1	Providing and fixing Ist quality ceramic glazed wall tiles conforming to IS: 15622 (thickness to be specified by the manufacturer), of approved make, in all colours, shades except burgundy, bottle green, black of any size as approved by Engineer-in-Charge, in skirting, risers of steps and dados, over 12 mm thick bed of cement mortar 1:3 (1 cement : 3 coarse sand) and jointing with grey cement slurry @ 3.3kg per sqm, including pointing in white cement mixed with pigment of matching shade complete.	324.81	sqm	942.75	306214.12	8.31
5.2	Providing and fixing 18 mm thick gang saw cut, mirror polished, premoulded and prepolished, machine cut for kitchen platforms, vanity counters, window sills, facias and similar locations of required size, approved shade, colour and texture laid over 20 mm thick base cement mortar 1:4 (1 cement : 4 coarse sand), joints treated with white cement, mixed with matching pigment, epoxy touch ups, including rubbing, curing, moulding and polishing to edges to give high gloss finish etc. complete at all levels.					8.2
5.2.1	Granite stone slab colour black, Cherry/Ruby red					8.2.2
5.2.1.1	Area of slab upto 0.50 sqm	0.90	sqm	4148.24	3733.42	8.2.2.1
5.2.1.2	Area of slab over 0.50 sqm	7.92	sqm	3923.07	31070.74	8.2.2.2
5.3	Extra for fixing marble/ granite stone, over and above corresponding basic item, in facia and drops of width upto 150 mm with epoxy resin based adhesive, including cleaning etc. complete.	7.80	mtr	421.58	3288.29	8.4
5.4	Extra for providing opening of required size & shape for wash basin/ kitchen sink in kitchen platform, vanity counter and similar location in marble/ Granite/ stone work, including necessary holes for pillar taps etc. including moulding, rubbing and polishing of cut edges etc. complete.	12.00	each	716.42	8597.10	8.5
6	WOOD AND PVC WORK					9
6.1	Providing wood work in frames of doors, windows, clerestory windows and other frames, wrought framed and fixed in position with hold fast lugs or with dash fasteners of required dia & length (hold fast lugs or dash fastener shall be paid for separately).					9.1
6.1.1	Second class teak wood	0.13	cum	116642.9	15163.59	9.1.1
6.2	Providing and fixing panelled or panelled and glazed shutters for doors, windows and clerestory windows, including ISI marked M.S. pressed butt hinges bright finished of required size with necessary screws, excluding panelling which will be paid for separately, all complete as per direction of Engineer- in-charge. (Note:- Butt hinges and necessary screws shall be paid separately)					9.5
6.2.1	Second class teak wood					9.5.1
6.2.1.1	35 mm thick shutters	4.2	sqm	3283.99	13792.78	9.5.1.1
6.3	Providing and fixing M.S. grills of required pattern in frames of windows etc. with M.S. flats, square or round bars etc. including priming coat with approved steel primer all complete.					9.48
6.3.1	Fixed to steel windows by welding	200	kg	160.46	32091.30	9.48.1

6.4	Providing and fixing ISI marked oxidised M.S. tower bolt black finish, (Barrel type) with necessary screws etc. complete :					9.63
6.4.1	200x10 mm	6	each	54.12	324.72	9.63.2
6.4.2	150x10 mm	13	each	47.03	611.37	9.63.3
6.5	Providing and fixing IS : 12817 marked stainless steel butt hinges (heavy weight) with stainless steel screws etc. complete :					9.71
6.5.1	100x60x2.50 mm	16	each	75.75	1212.02	9.71.2
6.5.2	75x50x2.50 mm	39	each	62.85	2451.26	9.71.3
6.6	Providing and fixing bright finished brass 100 mm mortice latch with one dead bolt and a pair of lever handles of approved quality with necessary screws etc. complete.	4	each	534.91	2139.66	9.77
6.7	Providing and fixing aluminium extruded section body tubular type universal hydraulic door closer (having brand logo with ISI, IS : 3564, embossed on the body, door weight upto 36 kg to 80 kg and door width from 701 mm to 1000 mm), with double speed adjustment with necessary accessories and screws etc. complete.	17	each	759.11	12904.87	9.84
6.8	Providing and fixing aluminium hanging floor door stopper, ISI marked, anodized (anodic coating not less than grade AC 10 as per IS: 1868) transparent or dyed to required colour and shade, with necessary screws etc. complete.					9.101
6.8.1	Twin rubber stopper	17	each	55.18	938.14	9.101.2
6.9	Providing and fixing factory made uPVC door frame made of uPVC extruded sections having an overall dimension as below (tolerance ± 1 mm), with wall thickness 2.0 mm (± 0.2 mm), corners of the door frame to be Jointed with galvanized brackets and stainless steel screws, joints mitred and Plastic welded. The hinge side vertical of the frames reinforced by galvanized M.S. tube of size 19 X 19 mm and 1mm (± 0.1 mm) wall thickness and 3 nos. stainless steel hinges fixed to the frame complete as per manufacturer's specification and direction of Engineer- in-charge					9.117
6.9.1	Extruded section profile size 42x50 mm	18.25	metre	248.84	4541.34	9.117.2
6.1	Providing and fixing to existing door frames.					9.118
6.10.1	30 mm thick factory made Polyvinyl Chloride (PVC) door shutter made of styles and rails of a uPVC hollow section of size 60x30 mm and wall thickness 2 mm (± 0.2 mm), with inbuilt decorative moulding edging on one side. The styles and rails mitred and joint at the corners by means of M.S. galvanised/ plastic brackets of size 75x220 mm having wall thickness 1.0 mm and stainless steel screws. The styles of the shutter reinforced by inserting galvanised M.S. tube of size 25x20 mm and 1 mm (± 0.1 mm) wall thickness. The lock rail made up of 'H' section, a uPVC hollow section of size 100x30 mm and 2 mm (± 0.2 mm) wall thickness fixed to the shutter styles by means of plastic/ galvanised M.S. 'U' cleats. The shutter frame filled with a uPVC multi-chambered single panel of size not less than 620 mm, having over all thickness of 20 mm and 1 mm (± 0.1 mm) wall thickness. The panels filled vertically and tie bar at two places by inserting horizontally 6 mm galvanised M.S. rod and fastened with nuts and washers, complete as per manufacturer's specification and direction of Engineer-in-charge.	7.98	sqm	1780.58	14209.03	9.118.2

7	STEEL WORK					
7.1	Structural steel work riveted, bolted or welded in built up sections, trusses and framed work, including cutting, hoisting, fixing in position and applying a priming coat of approved steel primer all complete.	200	kg	69.32	13864.86	10.2
7.2	Steel work in built up tubular (round, square or rectangular hollow tubes etc.) trusses etc., including cutting, hoisting, fixing in position and applying a priming coat of approved steel primer, including welding and bolted with special shaped washers etc. complete.					10.16
7.2.1	Hot finished seamless type tubes	2200	kg	149.77	329503.19	10.16.2
7.3	Steel work welded in built up sections/ framed work, including cutting, hoisting, fixing in position and applying a priming coat of approved steel primer using structural steel etc. as required.					10.25
7.3.1	In gratings, frames, guard bar, ladder, railings, brackets, gates and similar works	550	kg	126.15	69381.92	10.25.2
7.4	Providing and fixing hand rail of approved size by welding etc. to steel ladder railing, balcony railing, staircase railing and similar works, including applying priming coat of approved steel primer.					10.26
7.4.1	M.S. tube	100	kg	139.31	13931.35	10.26.1
7.5	Providing and fixing carbon steel galvanised (minimum coating 5 micron) dash fastener of 10 mm dia double threaded 6.8 grade (yield strength 480 N/mm ²), counter sunk head, comprising of 10 mm dia polyamide PA 6 grade sleeve, including drilling of hole in frame, concrete/ masonry, etc. as per direction of Engineer-in-charge.					10.27
7.5.1	10 x 60 mm	20	each	10.37	207.44	10.27.1
7.5.2	10 x 80 mm	20	each	103.99	2079.73	10.27.2
7.5.3	10 x 140 mm	30	each	138.60	4158.13	10.27.4
8	FLOORING					11
8.1	Chequered precast cement concrete tiles 22 mm thick in footpath & courtyard, jointed with neat cement slurry mixed with pigment to match the shade of tiles, including rubbing and cleaning etc. complete, on 20 mm thick bed of cement mortar 1:4 (1 cement: 4 coarse sand).					11.2
8.1.1	Light shade pigment using white cement	18	sqm	1093.10	19675.78	11.20.1
8.2	Kota stone slab flooring over 20 mm (average) thick base laid over and jointed with grey cement slurry mixed with pigment to match the shade of the slab, including rubbing and polishing complete with base of cement mortar 1 : 4 (1 cement : 4 coarse sand) :					11.26
8.2.1	25 mm thick	16.2	sqm	1512.90	24508.99	11.26.1
8.3	Kota stone slabs 20 mm thick in risers of steps, skirting, dado and pillars laid on 12 mm (average) thick cement mortar 1:3 (1 cement: 3 coarse sand) and jointed with grey cement slurry mixed with pigment to match the shade of the slabs, including rubbing and polishing complete.	8.1	sqm	1807.17	14638.11	11.27
8.4	Providing and laying Vitriified tiles in floor in different sizes (thickness to be specified by the manufacturer) with water absorption less than 0.08% and conforming to IS: 15622, of approved brand & manufacturer, in all colours and shade, laid on 20 mm thick cement mortar 1:4 (1 cement: 4 coarse sand) jointing with grey cement slurry @3.3 kg/sqm including grouting the joints with white cement and matching pigments etc. The tiles must be cut with the zero chipping diamond cutter only.					11.41A

	Laying of tiles will be done with the notch trowel, plier, wedge, clips of required thickness, leveling system and rubber mallet for placing the tiles gently and easily.					
8.4.1	Glazed Vitrified tiles Matt/Antiskid finish of size					11.41A.3
8.4.1.1	Size of Tile 600 x 600 mm	132.86	sqm	1162.25	154415.98	11.41A.3.1
9	ROOFING					12
9.1	Providing and fixing on wall face unplasticised Rigid PVC rain water pipes conforming to IS : 13592 Type A, including jointing with seal ring conforming to IS : 5382, leaving 10 mm gap for thermal expansion, (i) Single socketed pipes.					12.41
9.1.1	75 mm diameter	11	metre	188.82	2077.07	12.41.1
9.1.2	110 mm diameter	40	metre	283.46	11338.34	12.41.2
9.2	Providing and fixing on wall face unplasticised - PVC moulded fittings/ accessories for unplasticised Rigid PVC rain water pipes conforming to IS : 13592 Type A, including jointing with seal ring conforming to IS : 5382, leaving 10 mm gap for thermal expansion.					12.42
9.2.1	Coupler					12.42.1
9.2.1.1	75 mm	2	each	70.74	141.49	12.42.1.1
9.2.1.2	110 mm	2	each	106.34	212.67	12.42.1.2
9.2.2	Single tee with door					12.42.3
9.2.2.1	75x75x75 mm	2	each	125.48	250.97	12.42.3.1
9.2.2.2	110x110x110 mm	2	each	182.13	364.26	12.42.3.2
9.2.3	Single tee without door					12.42.4
9.2.3.1	75x75x75 mm	2	each	110.10	220.21	12.42.4.1
9.2.3.2	110x110x110 mm	2	each	169.10	338.20	12.42.4.2
9.2.4	Bend 87.5°					12.42.5
9.2.4.1	75 mm bend	4	each	81.38	325.52	12.42.5.1
9.2.4.2	110 mm bend	5	each	117.02	585.09	12.42.5.2
9.3	Providing and fixing pre-coated galvanised iron profile sheets (size, shape and pitch of corrugation as approved by Engineer- in-charge) 0.50 mm (+ 0.05 %) total coated thickness with zinc coating 120 grams per sqm as per IS: 277, in 240 mpa steel grade, 5-7 microns epoxy primer on both side of the sheet and polyester top coat 15-18 microns. Sheet should have protective guard film of 25 microns minimum to avoid scratches during transportation and should be supplied in single length upto 12 metre or as desired by Engineer-in- charge. The sheet shall be fixed using self-drilling /self-tapping screws of size (5.5x 55 mm) with EPDM seal, complete upto any pitch in horizontal/ vertical or curved surfaces, excluding the cost of purlins, rafters and trusses and including cutting to size and shape wherever required.	140.12	sqm	595.33	83417.51	12.50
10	FINISHING					13
10.1	12 mm cement plaster of mix :					13.4
10.1.1	1:4 (1 cement: 4 coarse sand)	700.02	sqm	272.38	190669.44	13.4.1
10.2	15 mm cement plaster on rough side of single or half brick wall of mix:					13.5
10.2.1	1:4 (1 cement: 4 coarse sand)	96.94	sqm	314.26	30464.78	13.5.1

10.3	Distempering with oil bound washable distemper of approved brand and manufacture to give an even shade :					13.41
10.3.1	New work (two or more coats) over and including water thinkable priming coat with cement primer	37.01	sqm	144.10	5333.16	13.41.1
10.4	Finishing walls with 100% Premium acrylic emulsion paint having VOC less than 50 gm/ litre and UV resistance as per IS 15489:2004, Alkali & fungal resistance, dirt resistance exterior paint of required shade (Company Depot Tinted) with silicon additives.					13.48A
10.4.1	New work (Two or more coats applied @ 1.43 litre/ 10 sqm. Over and including priming coat of exterior primer applied @ 0.90 litre/10 sqm.	243.64	sqm	136.92	33359.17	13.48A.1
11	SANITARY INSTALLATIONS					17
11.1	Providing and fixing water closet squatting pan (Indian type W.C. pan) with 100 mm sand cast Iron P or S trap, 10 litre low level white P.V.C. flushing cistern, including flush pipe, with manually controlled device (handle lever) conforming to IS : 7231, with all fittings and fixtures complete, including cutting and making good the walls and floors wherever required:					17.1
11.1.1	White Vitreous china Orissa pattern W.C. pan of size 580x440 mm with integral type foot rests	2	each	5125.17	10250.33	17.1.1
11.2	Providing and fixing white vitreous china pedestal type water closet (European type) with seat and lid, 10 litre low level white vitreous china flushing cistern & C.P. flush bend with fittings & C.I. brackets, 40 mm flush bend, overflow arrangement with specials of standard make and mosquito proof coupling of approved municipal design complete, including painting of fittings and brackets, cutting and making good the walls and floors wherever required :					17.3
11.2.1	W.C. pan with ISI marked white solid plastic seat and lid	13	each	6153.46	79995.01	17.3.1
11.3	Providing and fixing white vitreous china flat back half stall urinal of size 580x380x350 mm with white PVC automatic flushing cistern, with fittings, standard size C.P. brass flush pipe, spreaders with unions and clamps (all in C.P. brass) with waste fitting as per IS : 2556, C.I. trap with outlet grating and other couplings in C.P. brass, including painting of fittings and cutting and making good the walls and floors wherever required :					17.5
11.3.1	Single half stall urinal with 5 litre P.V.C. automatic flushing cistern	12	each	8978.74	107744.86	17.5.1
11.4	Providing and fixing wash basin with C.I. brackets, 15 mm C.P. brass pillar taps, 32 mm C.P. brass waste of standard pattern, including painting of fittings and brackets, cutting and making good the walls wherever require:					17.7
11.4.1	White Vitreous China Wash basin size 630x450 mm with a single 15 mm C.P. brass pillar tap	2	each	2629.00	5258.01	17.7.2
11.5	Extra for using coloured W.C. pan instead of white W.C. pan :					17.14
11.5.1	Orissa pattern W.C. pan 580x440 mm	2	each	367.68	735.35	17.14.1
11.6	Extra for using coloured pedestal type W.C pan (European type) with low level cistern of same colour instead of white vitreous china W.C pan and cistern.	13	each	148.27	1927.47	17.16
11.7	Providing and fixing 8 mm dia C.P. / S.S. Jet with flexible tube upto 1 metre long with S.S. triangular plate to European type W.C. of quality and make as approved by Engineer - in - charge.	13	each	263.78	3429.11	17.16A
11.8	Providing and fixing controlled flush, low level cistern made of vitreous china with all fittings complete.					17.19

11.9	Providing and fixing white vitreous china wash basin including making all connections but excluding the cost of fittings :					17.25
11.9.1	Flat back wash basin of size 630x450 mm	10	each	1019.12	10191.20	17.25.1
11.1	Providing and fixing P.V.C. waste pipe for sink or wash basin including P.V.C. waste fittings complete.					17.28
11.10.1	Flexible pipe					17.28.2
11.10.1.1	32 mm dia	10	each	92.51	925.06	17.28.2.1
11.10.1.2	40 mm dia	16	each	92.51	1480.10	17.28.2.2
11.11	Providing and fixing 100 mm sand cast Iron grating for gully trap.	4	each	40.11	160.46	17.29
11.12	Providing and fixing in position 25 mm diameter mosquito proof coupling of approved municipal design.	4	each	40.16	160.63	17.30
11.13	Providing and fixing 600x450 mm beveled edge mirror of superior glass (of approved quality) complete with 6 mm thick hard board ground fixed to wooden cleats with C.P. brass screws and washers complete.	2	each	1250.98	2501.97	17.31
11.14	Providing and fixing mirror of superior glass (of approved quality) and of required shape and size with plastic moulded frame of approved make and shade with 6 mm thick hard board backing :					17.32
11.14.1	Rectangular shape 1500x450 mm	10	each	1610.95	16109.48	17.32.4
11.15	Providing and fixing toilet paper holder :					17.34
11.15.1	C.P. brass	15	each	603.53	9052.94	17.34.1
11.16	Providing and fixing soil, waste and vent pipes :					17.35
11.16.1	100 mm dia					17.35.1
11.16.1.1	Sand cast iron S&S pipe as per IS: 1729	15	metre	902.50	13537.52	17.35.1.1
11.17	Providing and filling the joints with spun yarn, cement slurry and cement mortar 1:2 (1 cement : 2 fine sand) in S.C.I./ C.I. Pipes :					17.36
11.17.1	100 mm dia pipe	10	each	144.90	1448.98	17.36.2
11.18	Providing and fixing plain bend of required degree.					17.39
11.18.1	100 mm dia					17.39.1
11.18.1.1	Sand cast iron S&S as per IS - 1729	4	each	366.08	1464.32	17.39.1.1
11.19	Providing and fixing terminal guard :					17.56
11.19.1	100 mm					17.56.1
11.19.1.1	Sand cast iron S&S as per IS - 1729	4	each	348.31	1393.22	17.56.1.1
11.20	Providing and fixing CP Brass 32mm size Bottle Trap of approved quality & make and as per the direction of Engineer-in-charge.	12.00	each	785.66	9427.93	17.22A
11.21	Providing and fixing PTMT Waste Coupling for wash basin and sink, of approved quality and colour.					17.69
11.21.1	Waste coupling 31 mm dia of 79 mm length and 62mm breadth weighing not less than 45 gms	12.00	each	91.31	1095.71	17.69.1

12	WATER SUPPLY					
12.1	Providing and fixing Chlorinated Polyvinyl Chloride (CPVC) pipes, having thermal stability for hot & cold water supply, including all CPVC plain & brass threaded fittings, including fixing the pipe with clamps at 1.00 m spacing. This includes jointing of pipes & fittings with one step CPVC solvent cement and testing of joints complete as per direction of Engineer in Charge. Internal work - Exposed on wall					18.7
12.1.1	25 mm nominal outer dia Pipes	10	metre	362.18	3621.80	18.7.3
12.1.2	32 mm nominal outer dia Pipes	10	metre	444.09	4440.92	18.7.4
12.2	Providing and fixing Chlorinated Polyvinyl Chloride (CPVC) pipes, having thermal stability for hot & cold water supply, including all CPVC plain & brass threaded fittings, i/c fixing the pipe with clamps at 1.00 m spacing. This includes jointing of pipes & fittings with one step CPVC solvent cement and the cost of cutting chases and making good the same including testing of joints complete as per direction of Engineer in Charge. Concealed work, including cutting chases and making good the walls etc.					18.8
12.2.1	15 mm nominal dia Pipes	65	metre	391.08	25420.17	18.8.1
12.2.2	20 mm nominal dia Pipes	10	metre	455.44	4554.39	18.8.2
12.2.3	32 mm nominal dia Pipes	30.00	meter	631.85	18955.59	18.8.4
12.3	Providing and fixing gun metal gate valve with C.I. wheel of approved quality (screwed end) :					18.17
12.3.1	25 mm nominal bore	2	each	471.93	943.86	18.17.1
12.3.2	32 mm nominal bore.	2	each	522.95	1045.89	18.17.2
12.4	Providing and fixing uplasticised PVC connection pipe with brass unions :					18.21
12.4.1	45 cm length					18.21.2
12.4.1.1	15 mm nominal bore	6	each	75.53	453.18	18.21.2.1
12.5	Providing and fixing rectangular high density polyethylene water storage loft tank with cover, conforming to ISI: 12701, colour of opaque white or as approved by Engineer-in-charge. The rate includes making necessary holes for inlet, outlet & over flow pipes. The base support i/c fittings & fixtures for tank shall be paid separately.	2000	per litre	8.60	17198.10	18.48A
12.6	Providing and fixing C.P. brass bib cock of approved quality conforming to IS:8931 :					18.49
12.6.1	15 mm nominal bore	16	each	384.92	6158.69	18.49.1
12.7	Providing and fixing C.P. brass stop cock (concealed) of standard design and of approved make conforming to IS:8931.					18.52
12.7.1	15 mm nominal bore	4	each	527.25	2108.98	18.52.1
12.8	Providing and fixing C.P. brass angle valve for basin mixer and geyser points of approved quality conforming to IS:8931					18.53
12.8.1	15mm nominal bore	51	each	443.56	22621.57	18.53.1

13	DRAINAGE					19
13.1	Providing, laying and jointing glazed stoneware pipes class SP-1 with stiff mixture of cement mortar in the proportion of 1:1 (1 cement: 1 fine sand) including testing of joints etc. complete :					19.1
13.1.1	100 mm diameter	50	metre	333.10	16655.12	19.1.1
13.2	Providing and laying cement concrete 1:5:10 (1 cement : 5 coarse sand: 10 graded stone aggregate 40 mm nominal size) all-round S.W. pipes including bed concrete as per standard design :					19.2
13.2.1	100 mm diameter S.W. pipe	35	metre	793.86	27785.13	19.2.1
13.3	Providing and laying cement concrete 1:5:10 (1 cement : 5 coarse sand : 10 graded stone aggregate 40 mm nominal size) up to haunches of S.W. pipes including bed concrete as per standard design :					19.3
13.3.1	100 mm diameter S.W. pipe	25	metre	377.29	9432.36	19.3.1
13.4	Providing and fixing square-mouth S.W. gully trap class SP-1 complete with C.I. grating brick masonry chamber with water tight C.I. cover with frame of 300 x300 mm size (inside) the weight of cover to be not less than 4.50 kg and frame to be not less than 2.70 kg as per standard design:					19.4
13.4.1	100x100 mm size P type					19.4.1
13.4.1.1	With common burnt clay F.P.S. (non modular) bricks of class designation 7.5	2	each	2175.07	4350.14	19.4.1.1
13.5	Constructing brick masonry circular type manhole 0.91 m internal dia at bottom and 0.56m dia at top in cement mortar 1:4 (1 cement : 4 coarse sand), inside cement plaster 12 mm thick with cement mortar 1:3 (1 cement : 3 coarse sand) finished with a floating coat of neat cement, foundation concrete 1:3:6 mix (1 cement : 3 coarse sand : 6 graded stone aggregate 40 mm nominal size), and making necessary channel in cement concrete 1:2:4 (1 cement : 2 coarse sand : 4 graded stone aggregate 20 mm nominal size) finished with a floating coat of neat cement, all complete as per standard design :					19.9
13.5.1	0.91 m deep with S.F.R.C. cover and frame (heavy duty, HD-20 grade designation) 560 mm internal diameter conforming to I.S. 12592, total weight of cover and frame to be not less than 182 kg., fixed in cement concrete 1:2:4 (1 cement : 2 coarse sand: 4 graded stone aggregate 20 mm nominal size) including centering, shuttering all complete. (Excavation, foot rests and 12mm thick cement plaster at the external surface shall be paid for separately) :					19.9.1
13.5.1.1	With common burnt clay F.P.S. (non modular) bricks of class designation 7.5	8	each	10537.34	84298.70	19.9.1.1
13.6	Providing and fixing in position pre-cast R.C.C. manhole cover and frame of required shape and approved quality					19.19
13.6.1	M D - 10					19.19.2
13.6.1.1	Square shape 450 mm internal dimension	2	each	1114.69	2229.37	19.19.2.1
13.6.1.2	Circular shape 500 mm internal diameter	2	each	936.72	1873.44	19.19.2.2
13.6.2	H D - 20					19.19.3
13.6.2.1	Circular shape 560 mm internal diameter	2	each	1324.61	2649.22	19.19.3.1

13.7	Making connection of drain or sewer line with existing manhole including breaking into and making good the walls, floors with cement concrete 1:2:4 mix (1 cement : 2 coarse sand : 4 graded stone aggregate 20 mm nominal size) cement plastered on both sides with cement mortar 1:3 (1 cement : 3 coarse sand), finished with a floating coat of neat cement and making necessary channels for the drain etc. complete:					19.21
13.7.1	For pipes 100 to 250 mm diameter	2	each	606.10	1212.20	19.21.1
14	NEW TECHNOLOGIES AND MATERIALS					26
14.1	Providing & fixing false ceiling at all heights with GRG (Glass Fibre Reinforced Gypsum) false ceiling tiles of Size 595x595 mm of approved texture, design and patterns having moisture content less than 2%, humidity resistance of 99%, NRC0.50 to 0.75 as per IS 8225:1987, Noncombustible as per BS 476 (part 4)-1970 and light reflectance of 85% (minimum) to be laid in true horizontal level suspended on interlocking metal T-Grid of hot dipped galvanised iron section of 0.33mm thick (galvanized @ 120 grams per sqm including both sides) comprising of main-T runners of size 15x32 mm of length 3000 mm, cross - T of size 15x32 mm of length 1200 mm and secondary intermediate cross-T of size 15x32 mm of length 600mm to form grid module of size 600 x 600 mm, suspended from ceiling using galvanised mild steel items (galvanizing @ 80 grams per sqm) i.e. 50 mm long, 8 mm outer diameter M- 6 dash fasteners, 6 mm dia fully threaded hanger rod upto 1000 mm length and L-shape level adjuster of size 85x25x2 mm. Galvanised iron perimeter wall angle of size 24x24x0.40 mm of length 3000 mm to be fixed on periphery wall / partition with the help of plastic rawl plugs at 450 mm centre to centre and 40 mm long dry wall wood screws. The work shall be carried out as per specifications, drawing and as per directions of the Engineer-in-Charge.					26.26
14.1.1	With semi perforated 12 mm thick micro tegular edged GRG false ceiling tiles.	120.12	sqm	1498.58	180009.90	26.26.1
15	Market rate					50
15.1	Supply and Fixing of Aluminum Three Track Sliding Windows made from Jindal or equivalent make Powder Coated (50 micron pure polyester coating) Aluminum Sections as per detail given below.– Main aluminium tubular section frame of size 4"x1.75"x 16 gauge minimum weight of section shall be 5.24 kg. /15 Rft Three Track Section frame (3.5'' x 1.25'') minimum weight of section should not less than 4kg/15rft length in 16 Gauge Window Shutters sections of size 1.6"x0.70'' minimum weight of section should not less than 2.60 kg / 15 Rft length of section in 16 gauge With 5mm thick plain Modiguard, Saint Gobain, Asahi or equivalent makes glass on fixed part, 4mm plain glass on shutters & SS Mosquito Jali.	60	Sqft	380.00	22800.00	50.6
15.2	Providing and fixing of frosted glass film on glass garware/vista or equivalent make on glass.	60	Sqft	70.00	4200.00	50.7
15.3	Supply and fixing of chromium plated (CP) Automatic sensor pillar tap for wash basin with infra-red sensor system complete set for 15 mm nominal bore (having foam flow technology) with all associated work for completion as per GTS.	11	each	4800.00	52800.00	50.12

15.4	Supply and fixing of automatic electric urinal flusher of 220 volts (Ac), with all associated work for completion as per GTS.	16	each	4200.00	67200.00	50.13
15.5	Brick work with common burnt clay F.P.S. (non modular) bricks of class designation 7.5 in foundation, plinth and super structure (Boundary wall up to height 3.5 mtr) in: cement mortar 1:4 ratio by using existing bricks after proper cleaning and stacking of old bricks. (Excluding the cost of Bricks)	10	cum	2800.00	28000.00	50.23
15.6	Providing and fixing Powder coated Aluminium work for Partitions walls or doors with chaukhat frame with extruded built up standard tubular sections/ appropriate Z sections and other sections of approved make fixed with rawl plugs and screws or with fixing clips, or with or with expansion hold fasteners for fixing of vertical sections in the ceiling to support the frame including necessary filling up of gaps at junctions, top, bottom and sides with required PVC/ neoprene felt, etc. Aluminium sections shall be smooth, rust free, straight, mitered and jointed mechanically wherever required including cleat angle, Aluminium snap beading for glazing / paneling, C.P. brass/ stainless steel screws all complete as per architectural drawings and the direction of engineer-in-charge With powder coated aluminium section of 63.5mm X38.10mm (sectional weight of the Aluminium section should not be less than 4 Kg. for the sectional length of 15') with 12 mm thick both side pre-laminated flat pressed three layer of graded wood particle board conforming to IS:12823 grade I type II in paneling of partition walls or with float glass panes of 5 mm thickness (Modiguard, saint Gobain, Asahi or equivalent) paneling of required height complete in all respect including all hardware fittings (Excluding door closer) as per the direction of Engineer -in charge. Height may be varied as per site condition.	171	Sqft	250.00	42750.00	50.27
15.7	Providing and fixing of movable grab bar and Fixed grab bar (minimum 600 mm length) on wall for western closet SS-304 grade, jointless at least 25 mm dia with grip space of clear 30 mm of mounting wall.	2	Nos	10000.00	20000.00	
	Total of Civil works (A)				3517984	

B. ELECTRICAL WORKS

1	WIRING					1
1.1	Wiring for light point/ fan point/ exhaust fan point/ call bell point with 1.5 sq.mm FRLS PVC insulated copper conductor single core cable in surface / recessed medium class PVC conduit, with modular switch, modular plate, suitable GI box and earthing the point with 1.5 sq.mm FRLS PVC insulated copper conductor single core cable etc. as required.					1.1
1.1.1	Group A	30	Point	640.21	19206.28	1.10.1
1.2	Wiring for circuit/ submain wiring alongwith earth wire with the following sizes of FRLS PVC insulated copper conductor, single core cable in surface/ recessed medium class PVC conduit as required.					1.14
1.2.1	2 X 1.5 sq. mm + 1 X 1.5 sq. mm earth wire	150	Metre	130.36	19554.51	1.14.1
1.2.2	2 X 2.5 sq. mm + 1 X 2.5 sq. mm earth wire	100	Metre	149.11	14911.43	1.14.2
1.2.3	2 X 4 sq. mm + 1 X 4 sq. mm earth wire	60	Metre	178.58	10714.80	1.14.3
1.3	Supplying and fixing of following sizes of medium class PVC conduit along with accessories in surface/recess including cutting the wall and making good the same in case of recessed conduit as required.					1.21
1.3.1	25 mm	100	Metre	80.36	8036.10	1.21.2

1.3.2	32 mm	60	Metre	82.15	4928.81	1.21.3
1.4	Supplying and fixing following modular switch/ socket on the existing modular plate & switch box including connections but excluding modular plate etc. as required.					1.24
1.4.1	5/6 A switch	30	Each	75.90	2276.90	1.24.1
1.4.2	15/16 A switch	20	Each	117.86	2357.26	1.24.3
1.4.3	3 pin 5/6 A socket outlet	10	Each	99.11	991.12	1.24.4
1.4.4	6 pin 15/16 A socket outlet	6	Each	156.26	937.55	1.24.5
1.5	Supplying and fixing modular blanking plate on the existing modular plate & switch box excluding modular plate as required.	6	Each	28.57	171.44	1.26
1.6	Supplying and fixing following size/ modules, GI box along with modular base & cover plate for modular switches in recess etc. as required.					1.27
1.6.1	3 Module (100mmX75mm)	12	Each	238.40	2860.85	1.27.2
1.6.2	6 Module (200mmX75mm)	10	Each	297.34	2973.36	1.27.4
1.6.3	12 Module (200mmX150mm)	2	Each	387.52	775.04	1.27.6
1.7	Supplying and fixing brass batten/ angle holder including connection etc. as required.	4	Each	104.47	417.88	1.34
1.8	Installation of exhaust fan in the existing opening, including making good the damage, connection, testing, commissioning etc. as required.					1.5
1.8.1	Upto 450 mm sweep	2	Each	324.12	648.25	1.50.1
1.9	Extra for fixing the louvers/ shutters complete with frame for a exhaust fan of all sizes.	2	Each	150.01	300.01	1.51
1.1	Supplying and fixing suitable size GI box with modular plate and cover in front on surface or in recess, including providing and fixing 2 nos. 3 pin 5/6 A modular socket outlet and 2 nos. 5/6 A modular switch, connections etc. as required. (For light plugs to be used in non-residential buildings).	25	Each	519.67	12991.70	1.56
1.11	Supplying and fixing PVC batten/ angle holder including connections etc. as required.	5	Each	80.36	401.81	1.58
2	MCCB, MCB & DB'S					2
2.1	Providing and fixing following rating and breaking capacity and pole MCCB with thermomagnetic release and terminal spreaders in existing cubicle panel board including drilling holes in cubicle panel, making connections, etc. as required.					2.2
2.1.1	100 A, 30KA, FPMCCB	1	Each	6586.92	6586.92	2.2.13
2.2	Supplying and fixing of following ways surface/ recess mounting, vertical type, 415 V, TPN MCB distribution board of sheet steel, dust protected, duly powder painted, inclusive of 200 A tinned copper bus bar, common neutral link, earth bar, din bar for mounting MCBs (but without MCBs and incomer) as required. (Note: Vertical type MCB TPDB is normally used where 3 phase outlets are required.)					2.5
2.2.1	4 way (4 + 12), Double door	1	Each	5045.78	5045.78	2.5.1
2.3	Supplying and fixing 5 A to 32 A rating, 240/415 V, 10 kA, "C" curve, miniature circuit breaker suitable for inductive load of following poles in the existing MCB DB complete with connections, testing and commissioning etc. as required.					2.1
2.3.1	Single pole	24	Each	177.69	4264.49	2.10.1
2.3.2	Triple pole and neutral	1	Each	975.05	975.05	2.10.5
3	EARTHING					5
3.1	Earthing with copper earth plate 600 mm X 600 mm X 3 mm thick including accessories, and providing masonry enclosure with cover plate having locking arrangement and watering pipe of 2.7 metre long etc. with charcoal/ coke and salt as required.	1	Set	10530.86	10530.86	5.6



3.2	Supplying and laying 25 mm X 5 mm copper strip at 0.50 metre below ground as strip earth electrode, including connection/ terminating with nut, bolt, spring, washer etc. as required. (Jointing shall be done by overlapping and with 2 sets of brass nut bolt & spring washer spaced at 50mm)	10	Metre	761.64	7616.44	5.8
3.3	Providing and fixing 4.00 mm dia copper wire on surface or in recess for loop earthing along with existing surface/ recessed conduit/ submain wiring/ cable as required.	6	Metre	96.43	578.60	5.19
4	MV CABLE LAYING					7
4.1	Laying of one number PVC insulated and PVC sheathed / XLPE power cable of 1.1 KV grade of following size direct in ground including excavation and refilling the trench etc as required, but excluding sand cushioning and protective covering.					7.3
4.1.1	Upto 35 sq. mm	200	Metre	149.11	29822.86	7.3.1
4.2	Laying of one number PVC insulated and PVC sheathed / XLPE power cable of 1.1 KV grade of following size in the existing RCC/ HUME/ METAL pipe as required.					7.5
4.2.1	Upto 35 sq. mm	20	Metre	27.68	553.60	7.5.1
4.3	Laying and fixing of one number PVC insulated and PVC sheathed / XLPE power cable of 1.1 KV grade of following size on wall surface as required.					7.7
4.3.1	Upto 35 sq. mm (clamped with 1mm thick saddle)	60	Metre	34.82	2089.39	7.7.1
5	MV CABLE JOINTING & END TERMINATION					9
5.1	Supplying and making end termination with brass compression gland and aluminium lugs for following size of PVC insulated and PVC sheathed / XLPE aluminium conductor cable of 1.1 KV grade as required.					9.1
5.1.1	4 X 35 sq. mm (32mm)	2	Each	269.66	539.31	9.1.35
6	MARKET RATE					50
6.1	SITC of 12 inches, fresh air fan with louvers including connection, civil work etc if required in all respect.	6	Each	2000.00	12000.00	50.1
6.2	SITC of round recess mounted 15watt LED fitting of reputed make along with holder Make: Philips/Syska/Bajaj/Havells/equivalent	20	each	300.00	6000.00	50.3
6.3	2"x2"size recess/surface type LED Luminaries wattage (30w-40w) light intensity (system lumens) 80 Lm/watt for 3000 deg K, 90Lm/watt for 4000 deg K, 100Lm/watt for 6000deg k. The Luminaire body must be corrosion resistant, epoxy powder coated/anodizing. all fasteners must be nickle/chrome plate, operating voltage and frequency range 140V to 280V at 50hz AC. Diffuser material ply carbonate (UV stabilised) conformity to Indian standards IS: 10322/Part 5/sec-2/2012 and IS 161027 9PART 2/Sec 1): 2012 FOR RECESS TYPE	10	NOS	3000.00	30000.00	50.6
6.4	SITC of 16 inches wall fan of reputed make: CG, Havells. Bajaj or equivalent	2	each	1500.00	3000.00	50.9
6.5	supply of 4x35sqmm Al armoured XLPE PVC cable	300	metre	150.00	45000.00	50.1
	Total of Electrical items (B)				270058.35	
	Total of BOQ amount (Civil and Electrical works)				3788042.20	
A1	Tender Discount percentage quoted by Bidder i.e. Below DSR value (in figures)	(fill this row, if applicable or, cut this row)			(-) _____ %	
A2	Tender Discount percentage quoted by Bidder i.e. Below DSR value (in words)	(fill this row, if applicable or, cut this row)			(-) _____ %	
B1	Tender Premium percentage quoted by Bidder i.e. Above DSR value (In figures)	(fill this row, if applicable or, cut this row)			(+) _____ %	
B2	Tender Premium percentage quoted by Bidder i.e. Above DSR value (In words)	(fill this row, if applicable or, cut this row)			(+) _____ %	

Total BOQ worked out amount (in figures) (in Rs.) _____ (excl. GST)

Total BOQ worked out amount (in figures) (in Rs.) _____

_____ (excl. GST)



- Note: 1. GST amount shall be extra and paid by NSIC on actuals as per tender conditions.
2. Please fill carefully, either row A1 and A2, or B1 and B2 (as applicable and strike-off non-applicable A1, A2 or B1, B2).

Signature of Tenderer with seal